

# 6LRH & 6LM lines

Deepwell Borehole

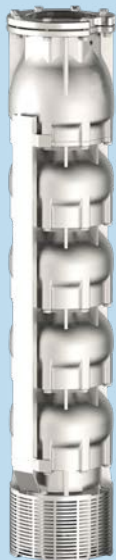

6LRH line



6LM line



Submersible Multistage Centrifugal Pumps for 6" Wells.

The 6LRH line is a radial type execution, while the 6LM one is a semi-axial type. These pumps feature a check valve integrated into the delivery outlet. The pump motor bracket is designed in compliance with NEMA standards. All components are constructed from stainless steel using lost wax microfusion technology. The standard material is AISI 304 stainless steel. Alternatively, the following materials are available upon request: AISI 316 stainless steel and Duplex steel (EN 1.4462). The bushing bearings and wear rings are made from sand abrasion-resistant rubber, while the reverse-thrust ring is crafted from PTFE/Graphite. These pumps are ideal for a variety of applications, including civil and agricultural use.

### General operating data:

- Capacity up to 108 m<sup>3</sup>/h
- Pressure up to 631 m
- Hydraulic efficiency 6", up to 78,5%
- Powers up to 44 kW
- Rotation speed 3.600 rpm
- Maximum depth: 350 m
- Maximum quantity of sand: 100 gr/m<sup>3</sup>
- Drinking water compatibility according to DM174 MEI >= 0,4 (EU directive No.547/2012)
- Performance tolerance: ISO9906-3B

### Construction features

<b>Suction and delivery outlet</b>	stainless steel AISI 304 (LRHS-LMS) stainless steel AISI 316 (LRHX-LMX) Duplex EN 1.4462 (LRHD-LMD)
<b>Valve</b>	stainless steel AISI 304 (LRHS-LMS) stainless steel AISI 316 (LRHX-LMX) Duplex EN 1.4462 (LRHD-LMD)
<b>Impellers and diffusers</b>	stainless steel AISI 304 (LRHS-LMS) stainless steel AISI 316 (LRHX-LMX) Duplex EN 1.4462 (LRHD-LMD)
<b>Upper bushings</b>	NBR rubber
<b>Shaft pump side</b>	stainless steel AISI 304 (LRHS-LMS) stainless steel AISI 316 (LRHX-LMX) Duplex EN 1.4462 (LRHD-LMD)
<b>Quantity of sand in the water</b>	max 100 g/m <sup>3</sup>

### Motor

<b>Asynchronous 2 pole</b>	rewindable water cooled
<b>Insulation class</b>	Y (max 30 °C) - PPC winding type F (max 50 °C) - PE2+PA or LPE winding type
<b>Protection degree</b>	IP68
<b>Liquid temperature</b>	max 30 °C (max 50 °C on request)
<b>Depth of immersion</b>	max 350 m



60 Hz - 3500 rpm			Q							
TYPE	P2		l/min	0	360	480	600	720	840	960
			l/sec	0	6	8	10	12	14	16
	HP	kW	m³/h	0	21,6	28,8	36	43,2	50,4	57,6
6LM 38/01	4	3	H (m)	21	18	17	16	15	13	10
6LM 38/02	7,5	5,5		41	37	35	33	29	25	20
6LM 38/03	10	7,5		62	55	52	49	44	38	29
6LM 38/04	12,5	9,2		82	73	69	65	59	50	39
6LM 38/05	17,5	13		103	91	86	81	73	63	49
6LM 38/06	20	15		124	110	104	98	88	75	59
6LM 38/07	25	18,5		144	128	121	114	103	88	69
6LM 38/08	25	18,5		165	146	138	130	118	100	78
6LM 38/09	30	22		185	165	156	146	132	113	88
6LM 38/10	35	26		206	183	173	163	147	125	98
6LM 38/11	35	26		227	201	190	179	162	138	108
6LM 38/12	40	30		247	219	207	195	176	150	118
6LM 38/13	40	30		268	238	225	212	191	163	127
6LM 38/14	50	37		288	256	242	228	206	175	137
6LM 38/15	50	37		309	274	259	244	220	188	147
6LM 38/16	50	37		329	293	276	260	235	200	157

Max Eff. % =	76
Max kW / St. =	2,3

NPSH (m)	Q=25%	Q=50%	Q=75%	Q=100%
	3,4	3,4	3,8	8

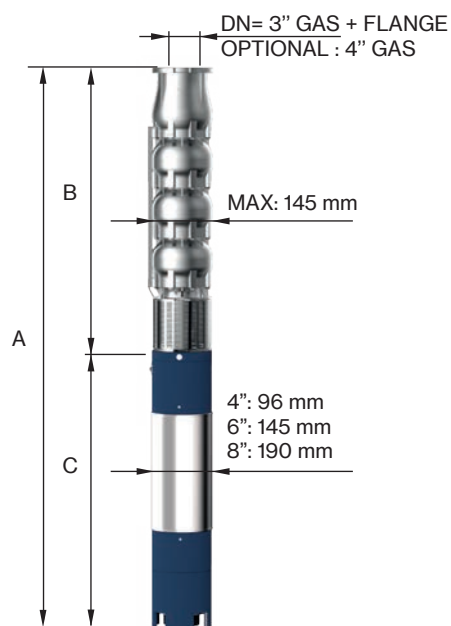

TYPE	MOTOR BRACKET	DIMENSIONS (mm)			WEIGHT (kg)	
		A	B	C	MOTOR	PUMP
6LM 38/01-4	4" NEMA	951	394	557	19	8
6LM 38/02-4		1193	495	698	27	12
6LM 38/03	6" NEMA	1297	596	701	55	15
6LM 38/04		1448	697	751	60	19
6LM 38/05		1639	798	841	70	22
6LM 38/06		1830	899	931	75	26
6LM 38/07		1991	1000	991	83	29
6LM 38/08		2092	1101	991	83	33
6LM 38/09		2273	1202	1071	92	37
6LM 38/10		2484	1303	1181	100	40
6LM 38/11		2585	1404	1181	100	44
6LM 38/12		2756	1505	1251	108	47
6LM 38/13		2857	1606	1251	108	51
6LM 38/14		3048	1707	1341	118	54
6LM 38/15		3149	1808	1341	118	58
6LM 38/16		3250	1909	1341	118	61

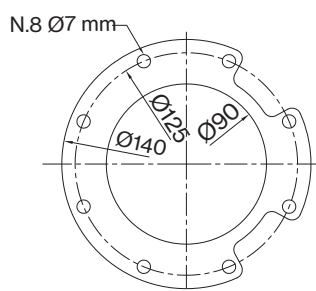

FOR COMMERCIAL TUBE  
EXTERNAL DIAMETER: 88,9 mm



# 6LM 38

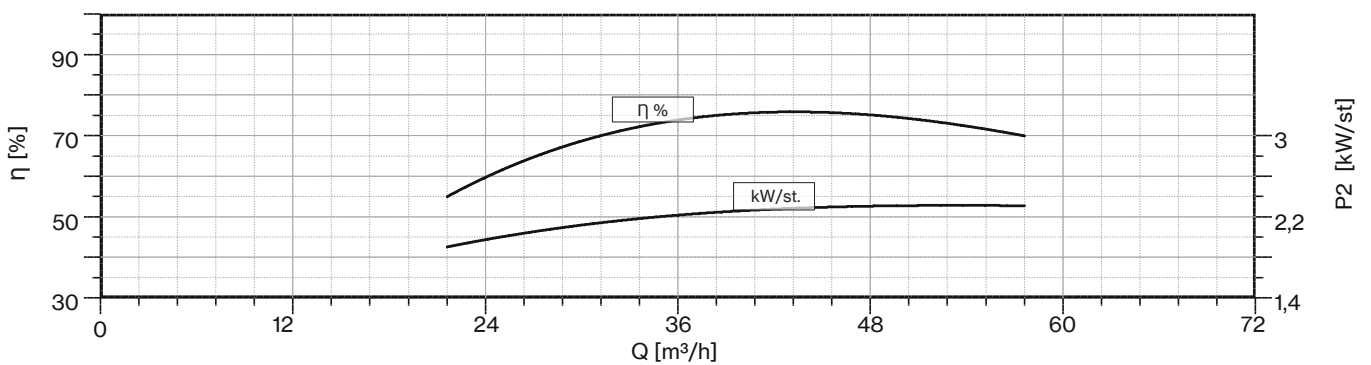
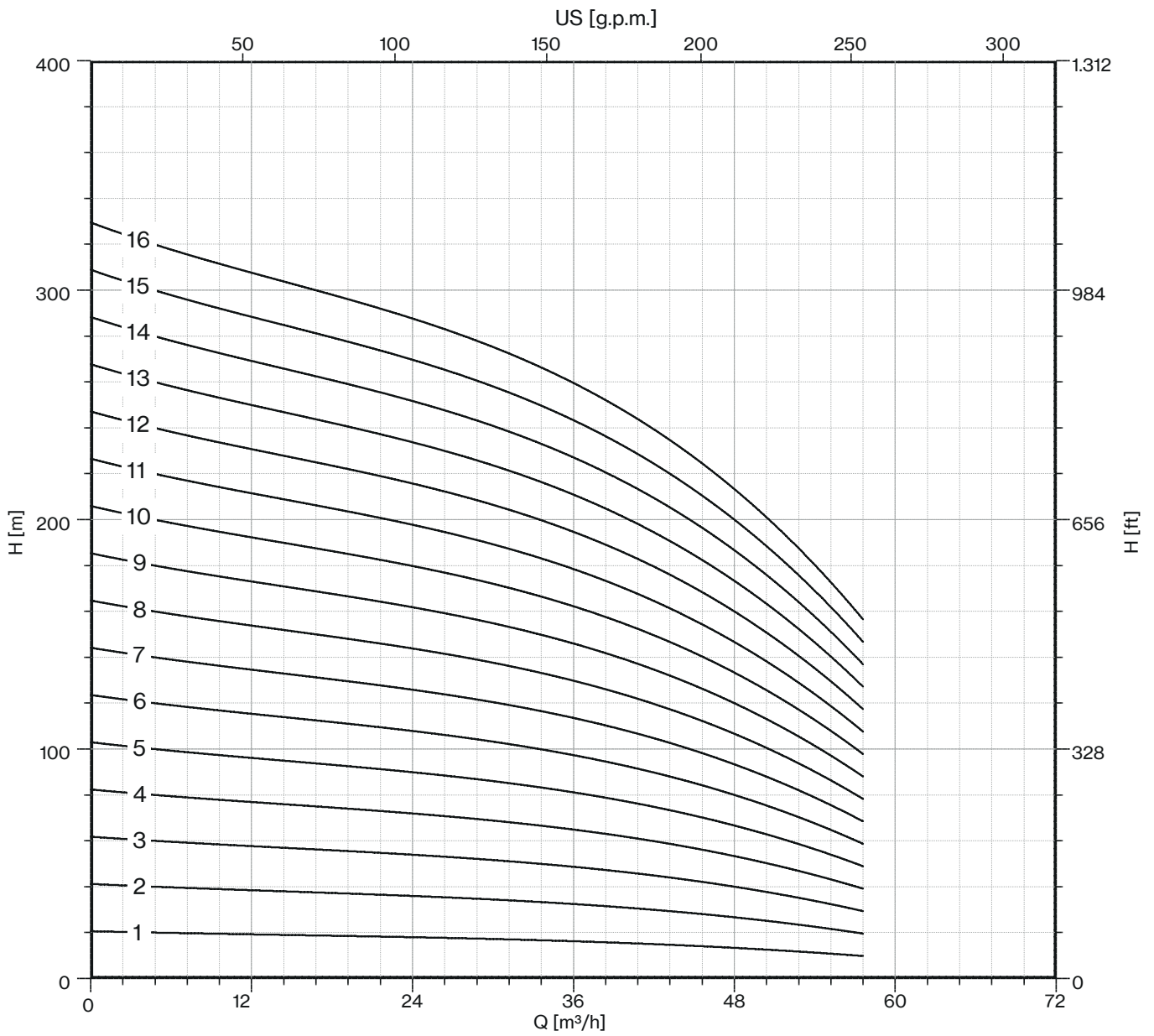

60 Hz - 3500 rpm			Q								
TYPE	P2		l/min	0	480	600	720	840	960	1080	1200
	HP	kW	l/sec	0	8	10	12	14	16	18	20
			m³/h	0	28,8	36	43,2	50,4	57,6	64,8	72
6LM 48/01	4	3	H (m)	20	16	16	15	14	13	11	9
6LM 48/02	7,5	5,5		40	33	32	31	28	25	21	18
6LM 48/03	10	7,5		60	49	48	46	42	38	32	28
6LM 48/04	15	11		81	66	64	61	56	51	43	37
6LM 48/05	17,5	13		101	82	80	76	71	63	53	46
6LM 48/06	20	15		121	98	96	92	85	76	64	55
6LM 48/07	25	18,5		141	115	112	107	99	89	75	65
6LM 48/08	30	22		161	131	128	122	113	101	85	74
6LM 48/09	35	26		181	148	144	137	127	114	96	83
6LM 48/10	35	26		202	164	160	153	141	127	107	92
6LM 48/11	40	30		222	181	176	168	155	139	117	101
6LM 48/12	40	30		242	197	192	183	169	152	128	111
6LM 48/13	50	37		262	213	208	198	183	165	139	120
6LM 48/14	50	37		282	230	224	214	198	177	149	129
6LM 48/15	50	37		302	246	240	229	212	190	160	138

Max Eff. % =	78,5
Max kW / St. =	2,5

NPSH (m)	Q=25%	Q=50%	Q=75%	Q=100%
	3,45	3,5	3,8	5

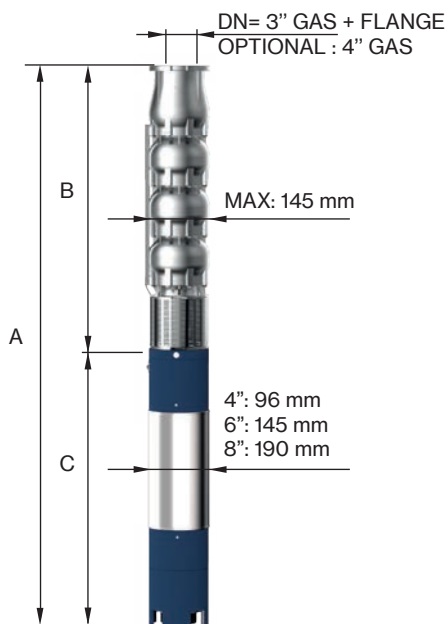

TYPE	MOTOR BRACKET	DIMENSIONS (mm)			WEIGHT (kg)	
		A	B	C	MOTOR	PUMP
6LM 48/01-4	4" NEMA	951	394	557	19	8
6LM 48/02-4		1193	495	698	27	12
6LM 48/03	6" NEMA	1297	596	701	55	15
6LM 48/04		1508	697	811	65	19
6LM 48/05		1639	798	841	70	22
6LM 48/06		1830	899	931	75	26
6LM 48/07		1991	1000	991	83	29
6LM 48/08		2172	1101	1071	92	33
6LM 48/09		2383	1202	1181	100	37
6LM 48/10		2484	1303	1181	100	40
6LM 48/11		2655	1404	1251	108	44
6LM 48/12		2756	1505	1251	108	47
6LM 48/13	2947	1606	1341	118	51	
6LM 48/14	3048	1707	1341	118	54	
6LM 48/15	3149	1808	1341	118	58	

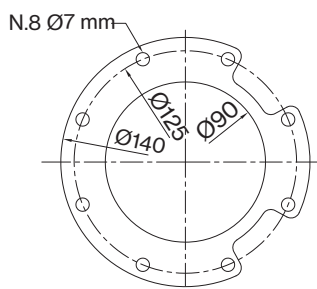

FOR COMMERCIAL TUBE  
EXTERNAL DIAMETER: 88,9 mm



# 6LM 48

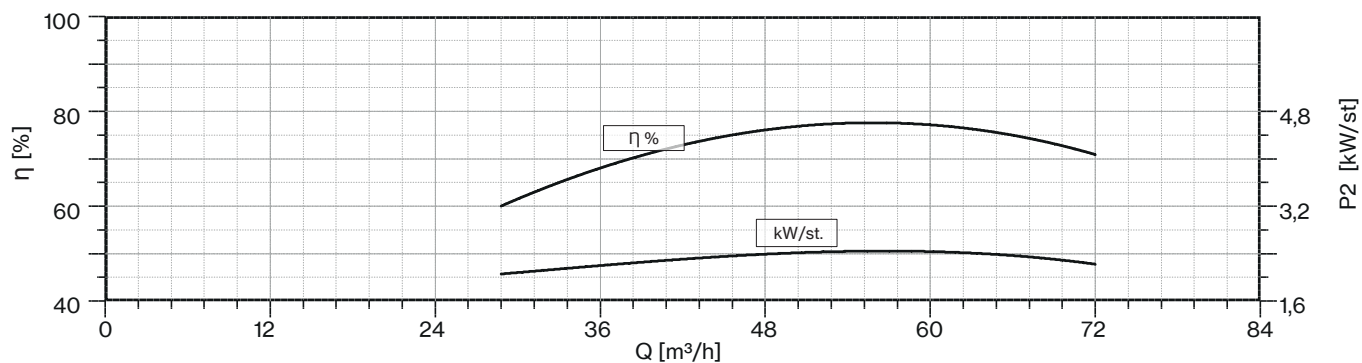
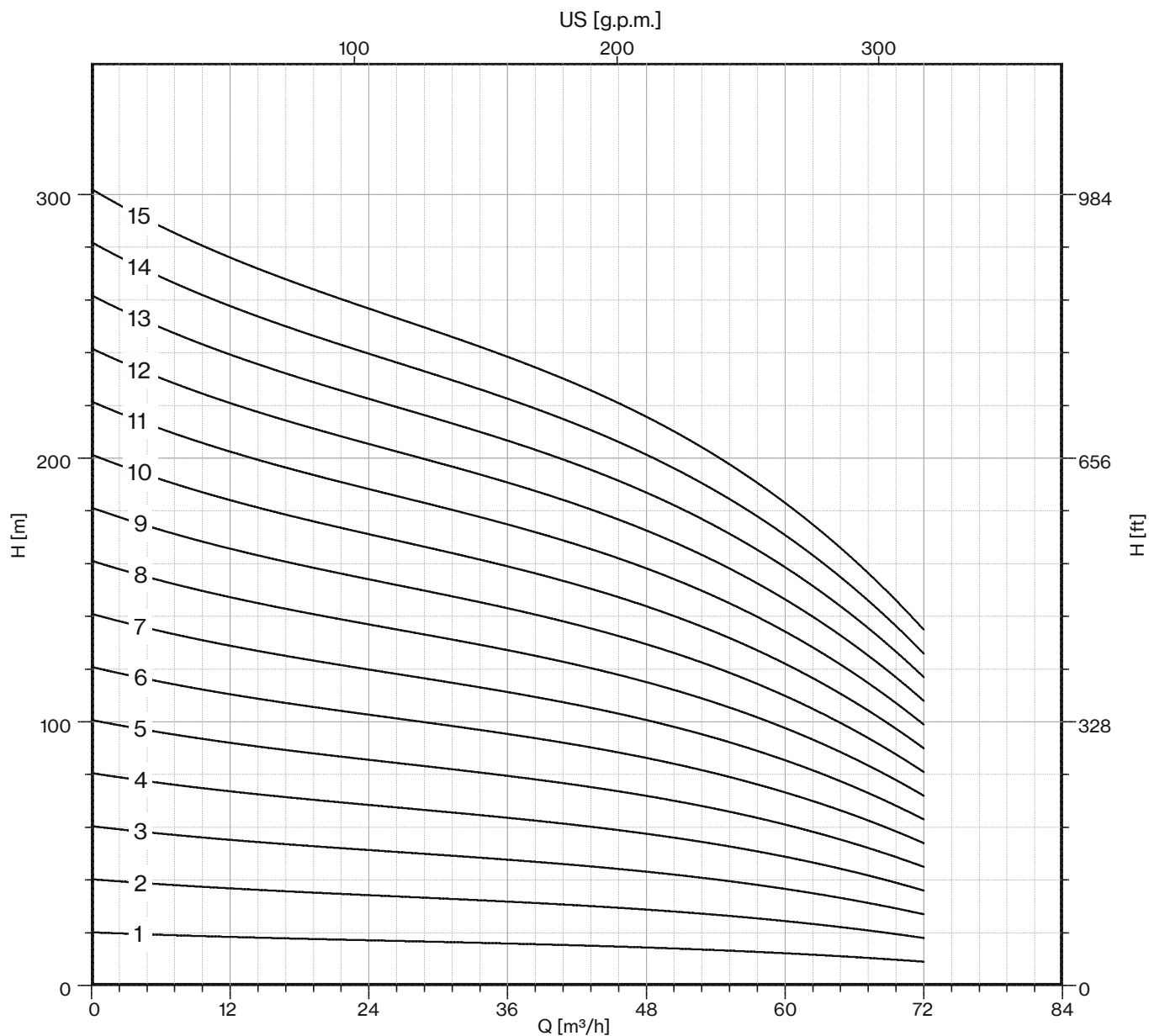

60 Hz - 3500 rpm			Q								
TYPE	P2		l/min	0	720	840	960	1080	1200	1320	1440
	HP	kW	l/sec	0	12	14	16	18	20	22	24
			m³/h	0	43,2	50,4	57,6	64,8	72	79,2	86,4
6LM 60/01	4	3	H (m)	20	15	14	13	12	11	10	9
6LM 60/02	7,5	5,5		39	30	28	26	24	22	20	17
6LM 60/03	12,5	9,2		59	44	41	39	37	34	30	26
6LM 60/04	17,5	13		79	59	55	52	49	45	40	35
6LM 60/05	20	15		99	74	69	66	61	56	50	43
6LM 60/06	25	18,5		118	89	83	79	73	67	60	52
6LM 60/07	30	22		138	104	97	92	86	79	70	60
6LM 60/08	35	26		158	119	111	105	98	90	79	69
6LM 60/09	35	26		178	133	124	118	110	101	89	78
6LM 60/10	40	30		197	148	138	131	122	112	99	86
6LM 60/11	50	37		217	163	152	144	135	124	109	95
6LM 60/12	50	37		237	178	166	157	147	135	119	104
6LM 60/13	50	37		256	193	180	170	159	146	129	112
6LM 60/15	60	44		295	223	208	196	183	168	149	129

Max Eff. % =	77
Max kW / St. =	2,85

NPSH (m)	Q=25%	Q=50%	Q=75%	Q=100%
	3,8	3,8	5,1	7,1

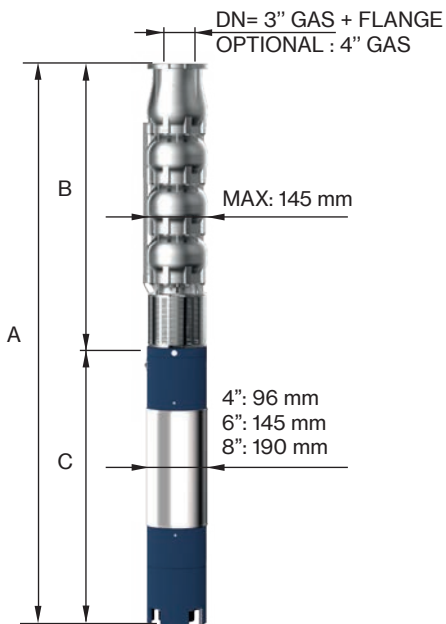

TYPE	MOTOR BRACKET	DIMENSIONS (mm)			WEIGHT (kg)	
		A	B	C	MOTOR	PUMP
6LM 60/01-4	4" NEMA	957	400	557	19	8
6LM 60/02-4		1205	507	698	27	12
6LM 60/03	6" NEMA	1365	614	751	60	16
6LM 60/04		1562	721	841	70	20
6LM 60/05		1759	828	931	75	24
6LM 60/06		1926	935	991	83	27
6LM 60/07		2113	1042	1071	92	31
6LM 60/08		2330	1149	1181	100	35
6LM 60/09		2437	1256	1181	100	39
6LM 60/10		2614	1363	1251	108	43
6LM 60/11		2811	1470	1341	118	46
6LM 60/12		2918	1577	1341	118	50
6LM 60/13	3025	1684	1341	118	54	
6LM 60/15-8	8" NEMA	3021	1898	1123	178	62

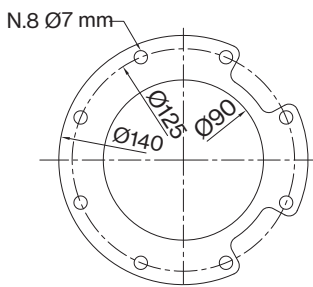

FOR COMMERCIAL TUBE  
EXTERNAL DIAMETER: 88,9 mm



# 6LM 60

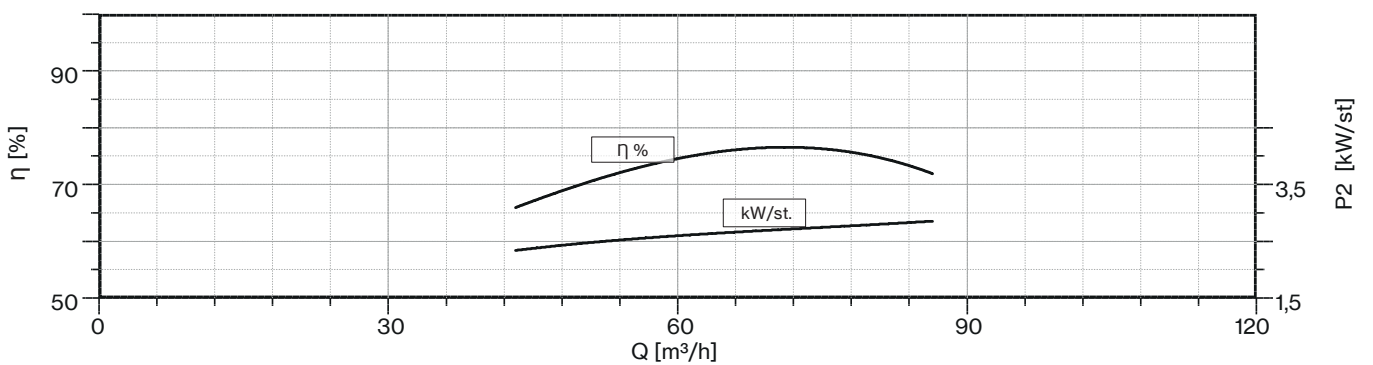
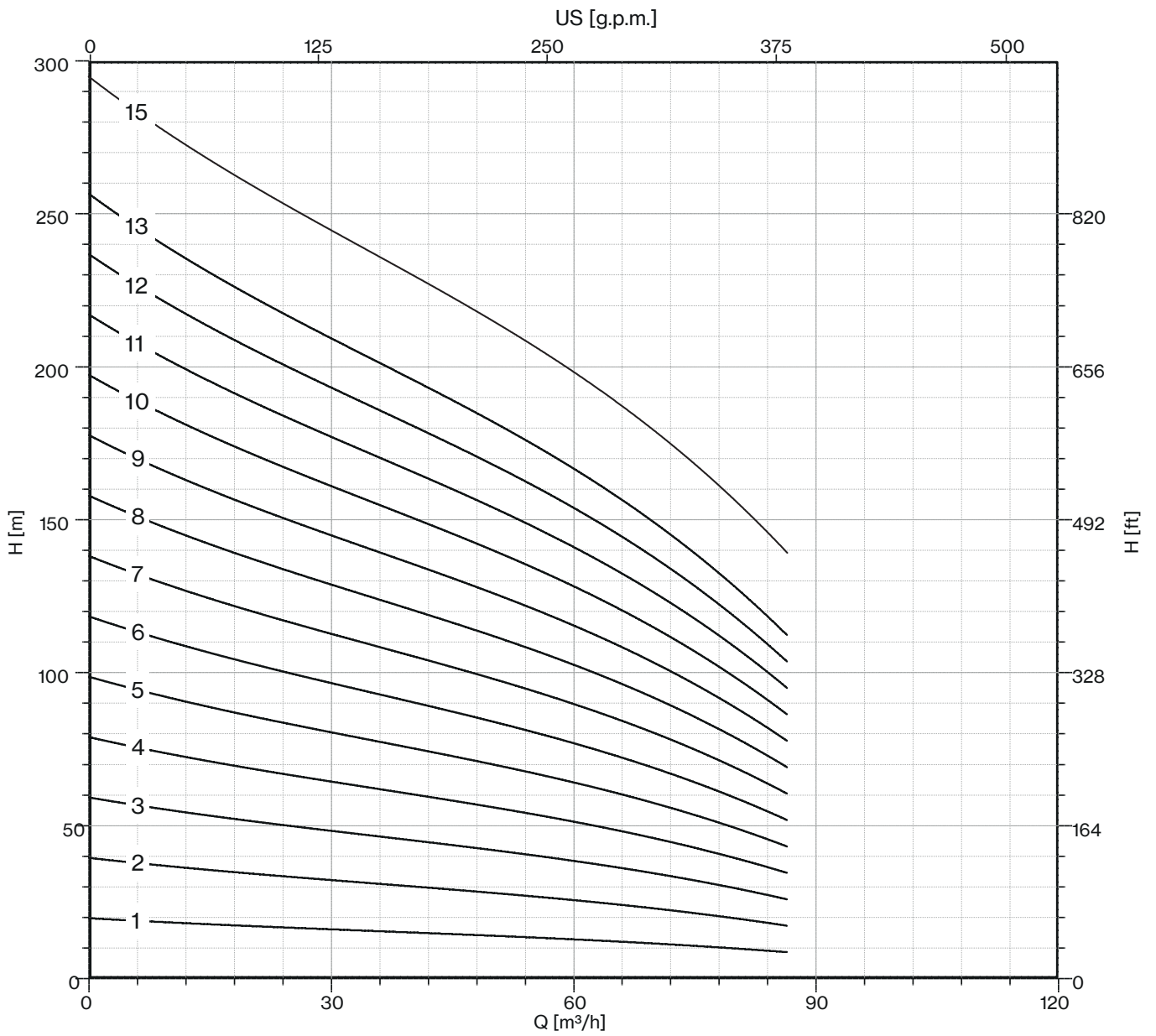

60 Hz - 3500 rpm			Q										
TYPE	P2		l/min	0	840	960	1080	1200	1320	1440	1560	1680	1800
	HP	kW	l/sec	0	14	16	18	20	22	24	26	28	30
			m <sup>3</sup> /h	0	50,4	57,6	64,8	72	79,2	86,4	93,6	100,8	108
6LM 70/01	5,5	4	H (m)	18,9	15	14,3	13,7	13,5	13,1	12,2	10,9	9,5	8,1
6LM 70/02	10	7,5		37,7	30	28,5	27,4	27,1	26,2	24,5	21,9	19,0	16,1
6LM 70/03	15	11		56,6	44,9	42,8	41,0	40,6	39,3	36,7	32,8	28,5	24,2
6LM 70/04	20	15		75	60	57	55	54	52	49	44	38	32
6LM 70/05	25	18,5		94	75	71	68	68	66	61	55	48	40
6LM 70/06	30	22		113	90	86	82	81	79	73	66	57	48
6LM 70/07	35	26		132	105	100	96	95	92	86	77	67	56
6LM 70/08	40	30		151	120	114	109	108	105	98	88	76	65
6LM 70/09	50	37		170	135	128	123	122	118	110	98	86	73
6LM 70/10	50	37		189	150	143	137	135	131	122	109	95	81

Max Eff. % =	76
Max kW / St. =	3,8

NPSH (m)	Q=25%	Q=50%	Q=75%	Q=100%
	3,8	3,8	5,1	7,1

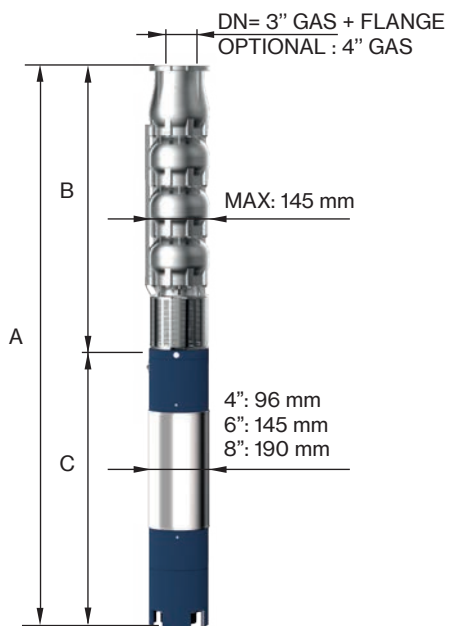

TYPE	MOTOR BRACKET	DIMENSIONS (mm)			WEIGHT (kg)	
		A	B	C	MOTOR	PUMP
6LM 70/01-4	4" NEMA	997	400	597	22	9
6LM 70/02	6" NEMA	1208	507	701	55	14
6LM 70/03		1425	614	811	65	18
6LM 70/04		1652	721	931	75	23
6LM 70/05		1819	828	991	83	27
6LM 70/06		2006	935	1071	92	32
6LM 70/07		2223	1042	1181	100	36
6LM 70/08		2400	1149	1251	108	41
6LM 70/09		2597	1256	1341	118	45
6LM 70/10		2704	1363	1341	118	50

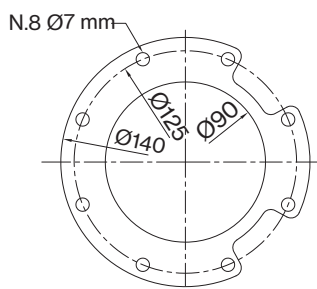

FOR COMMERCIAL TUBE  
EXTERNAL DIAMETER: 88,9 mm



# 6LM 70

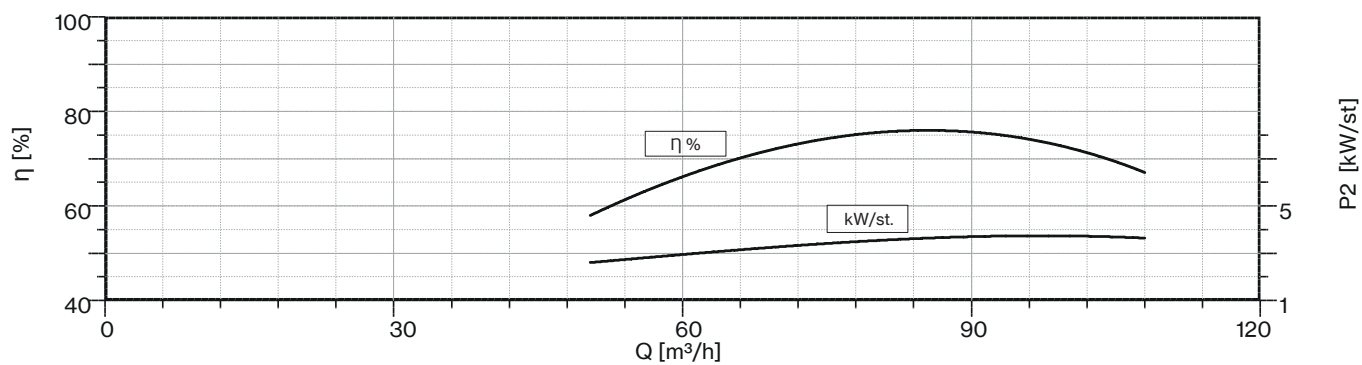
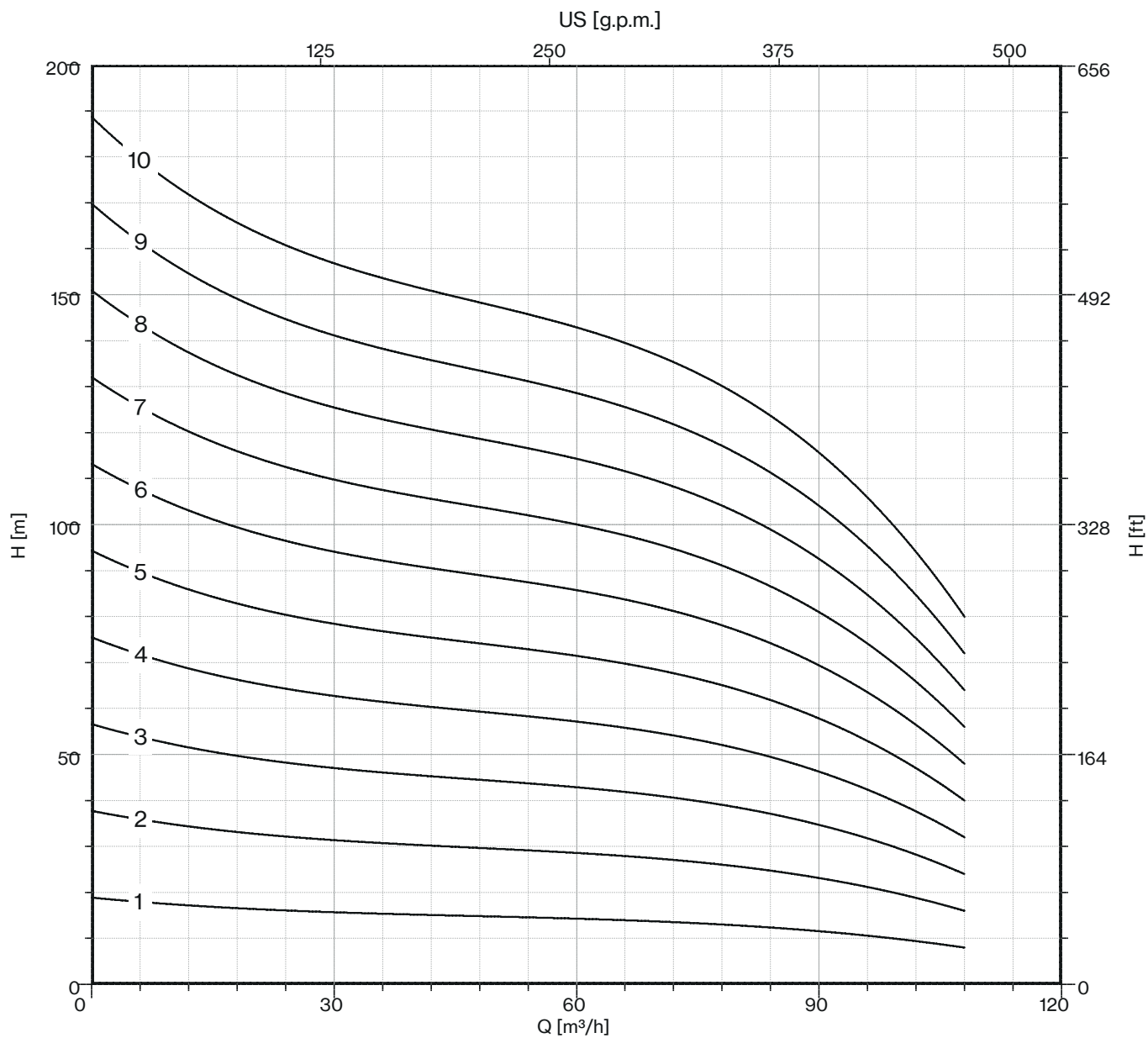

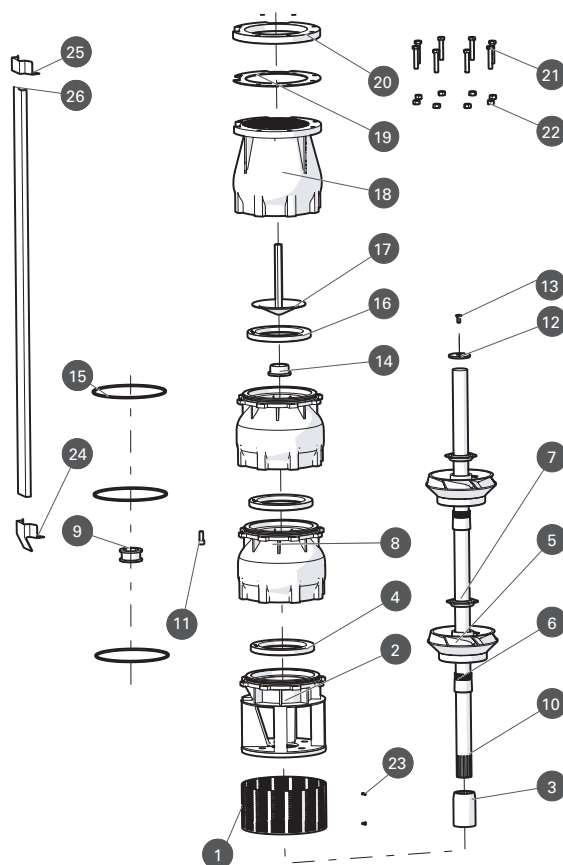

N. CODE	DESCRIPTION	LMS EXECUTION	LMX EXECUTION	LMD EXECUTION	(*) Q.TY
1	<b>SUCTION STRAINER</b>	AISI 304	AISI 316	Duplex EN 1.4462	-
2	<b>MOTOR BRACKET</b>	AISI 304	AISI 316	Duplex EN 1.4462	-
3	<b>COUPLING</b>	AISI 304	AISI 316	Duplex EN 1.4462	1
4	<b>WEAR RING</b>	NBR	NBR	NBR	N° of Stages
5	<b>IMPELLER</b>	AISI 304	AISI 316	Duplex EN 1.4462	-
6	<b>CONE</b>	AISI 304	AISI 316	Duplex EN 1.4462	N° of Stages
7	<b>HEXAGONAL RING</b>	AISI 304	AISI 316	Duplex EN 1.4462	N° of Stages
8	<b>DIFFUSEUR</b>	AISI 304	AISI 316	Duplex EN 1.4462	-
9	<b>BEARING BUSH</b>	NBR	NBR	NBR	N° of Stages
10	<b>PUMP SHAFT</b>	AISI 304	AISI 316	Duplex EN 1.4462	1
11	<b>N.8 SCREW FOR DIFFUSEUR</b>	AISI 304	AISI 316	Duplex EN 1.4462	-
12	<b>RING</b>	AISI 304	AISI 316	Duplex EN 1.4462	1
13	<b>SCREW FOR DISK</b>	AISI 304	AISI 316	Duplex EN 1.4462	1
14	<b>COUNTERTHRUST</b>	PTFE+25% CARBON	PTFE+25% CARBON	PTFE+25% CARBON	1
15	<b>O-RING</b>	NBR	NBR	NBR	N° of Stages
16	<b>GASKET VALVE</b>	NBR	NBR	NBR	1
17	<b>CAP VALVE</b>	AISI 304	AISI 316	Duplex EN 1.4462	-
18	<b>BODY VALVE</b>	AISI 304	AISI 316	Duplex EN 1.4462	-
19	<b>SEAL COUNTERFLANGE</b>	NBR	NBR	NBR	1
20	<b>COUNTERFLANGE</b>	AISI 304	AISI 316	Duplex EN 1.4462	-
21	<b>N.8 SCREW FOR COUNTERFLANGE</b>	AISI 304	AISI 316	Duplex EN 1.4462	-
22	<b>N.8 NUT FOR COUNTERFLANGE</b>	AISI 304	AISI 316	Duplex EN 1.4462	-
23	<b>N.2 SCREW FOR SUCTION STRAINER</b>	AISI 304	AISI 316	Duplex EN 1.4462	-
24	<b>LOWER CLAMP</b>	AISI 304	AISI 316	Duplex EN 1.4462	-
25	<b>UPPER CLAMP</b>	AISI 304	AISI 316	Duplex EN 1.4462	-
26	<b>COVER CABLE</b>	AISI 304	AISI 316	Duplex EN 1.4462	-

\* Recommended spare parts quantity

