

6-8-10LMG lines

Deepwell Borehole

Submersible multistage centrifugal pumps for 6", 8", 10" wells. Check valve built into the delivery outlet. The motor bracket and coupling are made according to NEMA standards. Most common applications are civil and agricultural.

Construction features

Suction and delivery outlet	cast iron GG25
Valve	stainless steel AISI 304
Impellers and diffusers	cast iron GG25; AISI 304 impeller on request
Upper bushings	NBR rubber
Shaft pump side	stainless steel AISI 304
Quantity of sand in the water	max 50 g/m ³

Motor

Asynchronous 2 pole	rewindable water cooled
Insulation class	Y (max 30 °C) - PPC winding type F (max 50 °C) - PE2+PA or LPE winding type
Protection degree	IP68
Liquid temperature	max 30 °C (max 50 °C on request)
Depth of immersion	max 350 m

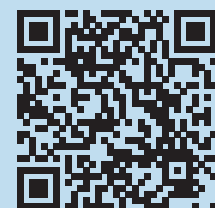

8LMG 80

50 Hz - 2900 rpm				Q							
TYPE	SUITABLE MOTOR 3- 400V		I/min	0	600	800	1000	1200	1400	1600	
	P2		CURRENT	I/sec	0	10,00	13,33	16,67	20,00	23,33	26,67
	HP	kW	A	m³/h	0	36	48	60	72	84	96
8LMG 80/01	7,5	5,5	12,5	H (m)	26	22	21	19	18	15	11
8LMG 80/02	15	11	24,5		53	45	42	39	35	30	23
8LMG 80/03	20	15	32		79	67	63	58	53	44	34
8LMG 80/04	30	22	47,5		105	89	84	78	70	59	45
8LMG 80/05	35	26	55		131	111	105	97	88	74	56
8LMG 80/06	40	30	62,5		158	134	126	116	105	89	68
8LMG 80/07	50	37	78		184	156	147	136	123	103	79
8LMG 80/08	60	45	92		210	178	168	155	140	118	90
8LMG 80/09	60	45	92		236	200	189	174	158	133	101
8LMG 80/10	75	55	113,5		263	223	210	194	175	148	113
8LMG 80/11	75	55	113,5		289	245	231	213	193	162	124
8LMG 80/12	90	66	134,5		315	267	252	233	210	177	135
8LMG 80/13	90	66	134,5		341	289	273	252	228	192	146
8LMG 80/14	100	75	149,5		368	312	294	271	245	207	158
8LMG 80/15	100	75	149,5		394	334	315	291	263	221	169

Max Eff. %	70
Max kW / St.	5,1

NPSH (m)	Q=25%	Q=50%	Q=75%	Q=100%
	3	3	3,5	4,5

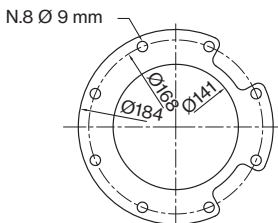
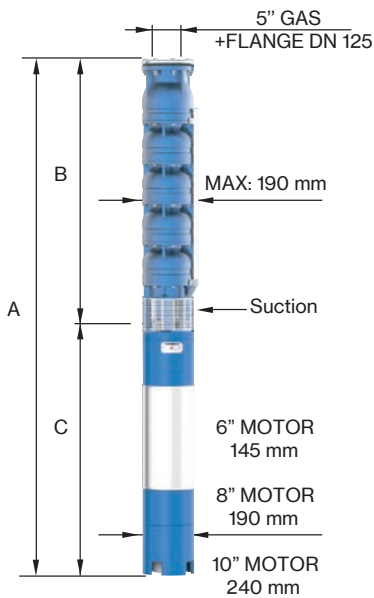

FOR COMMERCIAL TUBE
EXTERNAL DIAMETER: 139,7 mm

TYPE	MOTOR BRACKET	DIMENSIONS (mm)			WEIGHT (kg)	
		A	B	C	MOTOR	PUMP
8LMG 80/01-6	6" NEMA	1198	527	671	45	23
8LMG 80/02-6		1463	652	811	65	31
8LMG 80/03-6		1708	777	931	75	39
8LMG 80/04-6		1973	902	1071	92	48
8LMG 80/05-6		2208	1027	1181	100	56
8LMG 80/06-6		2403	1152	1251	108	64
8LMG 80/07-6		2618	1277	1341	118	73
8LMG 80/08	8" NEMA	2525	1402	1123	178	81
8LMG 80/09		2650	1527	1123	178	89
8LMG 80/10		2885	1652	1233	200	98
8LMG 80/11		3010	1777	1233	200	106
8LMG 80/12		3205	1902	1303	214	114
8LMG 80/13		3330	2027	1303	214	122
8LMG 80/14		3535	2152	1383	230	131
8LMG 80/15		3660	2277	1383	230	139



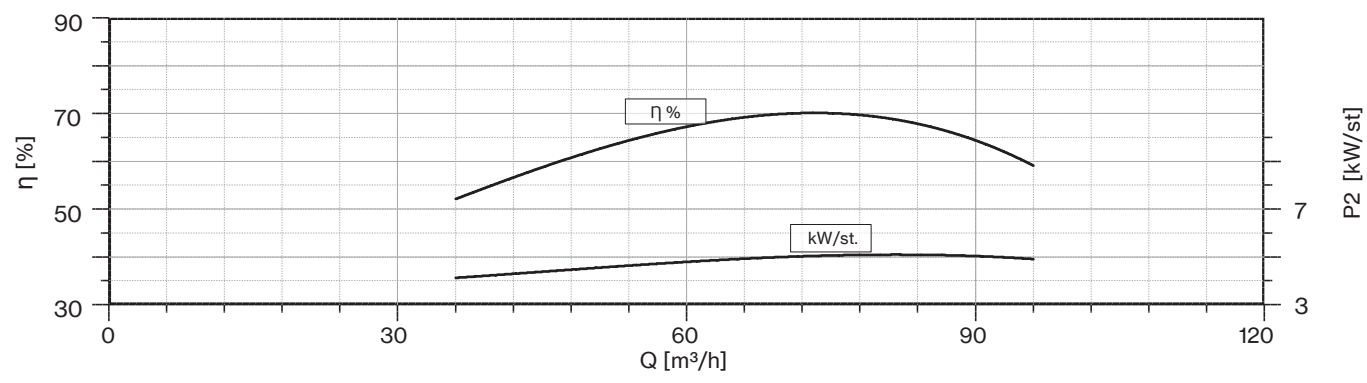
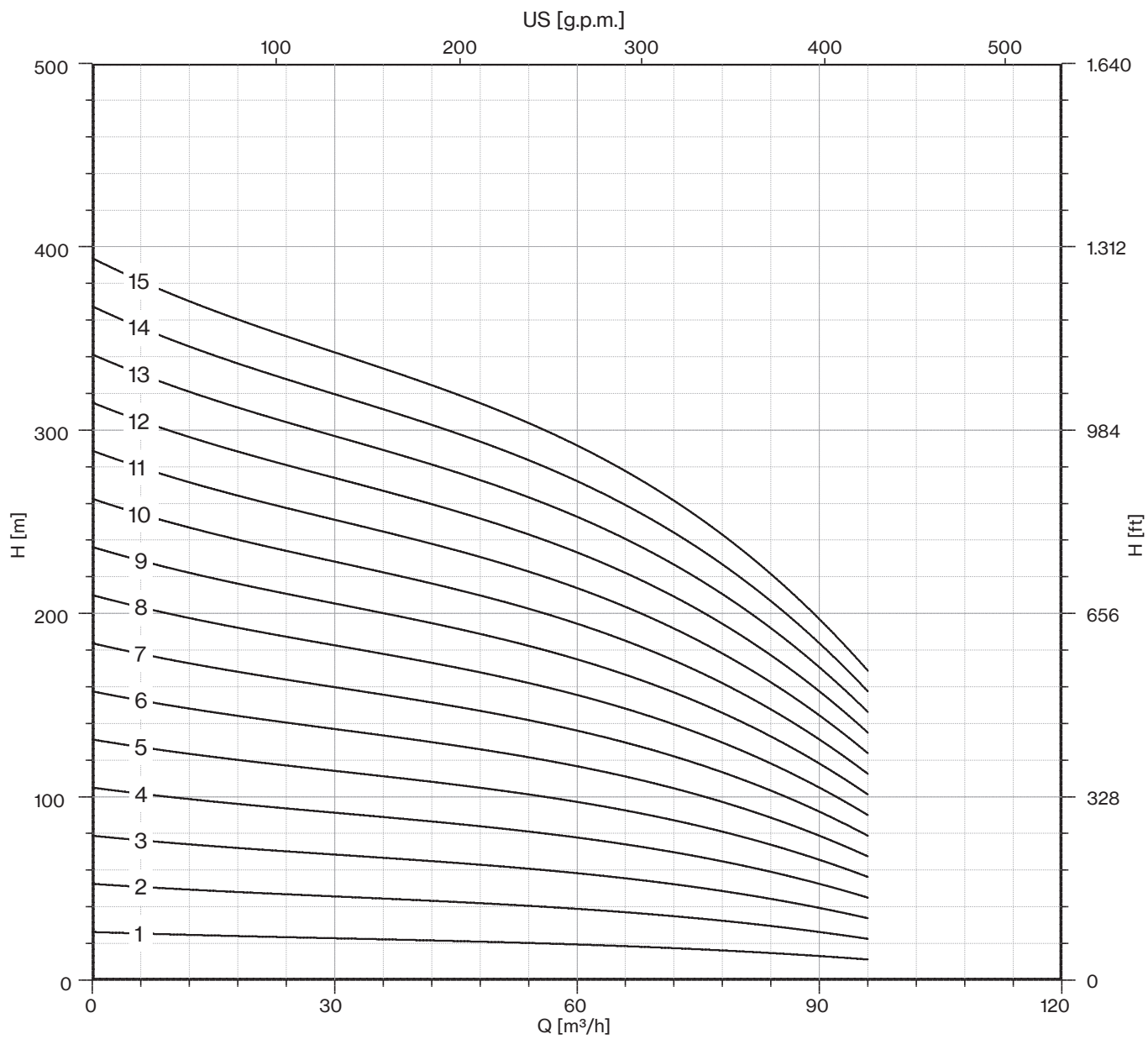

8LMG 92

50 Hz - 2900 rpm				Q								
TYPE	SUITABLE MOTOR 3- 400V		I/min	0	800	1000	1200	1400	1600	1800	2000	
	P2		CURRENT	I/sec	0	13,33	16,67	20,00	23,33	26,67	30,00	33,33
	HP	kW	A	m³/h	0	48	60	72	84	96	108	120
8LMG 92/01	10	7,5	17,5	H (m)	26	22	21	20	18	15	13	10
8LMG 92/02	17,5	13	28		53	44	42	39	35	31	25	20
8LMG 92/03	25	18,5	40		79	66	63	59	53	46	38	29
8LMG 92/04	35	26	55		105	89	84	78	70	61	50	39
8LMG 92/05	40	30	62,5		131	111	104	98	88	76	63	49
8LMG 92/06	50	37	78		158	133	125	117	105	92	75	59
8LMG 92/07	60	45	92		184	155	146	137	123	107	88	68
8LMG 92/08	75	55	113,5		210	177	167	156	140	122	100	78
8LMG 92/09	75	55	113,5		236	199	188	176	158	137	113	88
8LMG 92/10	90	66	134,5		263	221	209	195	175	153	125	98
8LMG 92/11	90	66	134,5		289	243	230	215	193	168	138	107
8LMG 92/12	100	75	149,5		315	266	251	234	210	183	150	117
8LMG 92/13	100	75	149,5		341	288	271	254	228	198	163	127
8LMG 92/14	125	92	185		368	310	292	273	245	214	175	137
8LMG 92/15	125	92	185		394	332	313	293	263	229	188	146

Max Eff. %	70
Max kW / St.	5,9

NPSH (m)	Q=25%	Q=50%	Q=75%	Q=100%
	3	4	5	8

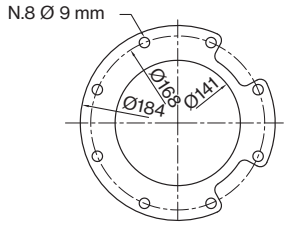
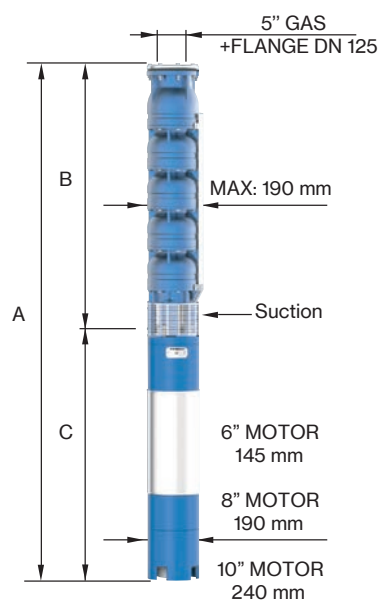

FOR COMMERCIAL TUBE
EXTERNAL DIAMETER: 139,7 mm

TYPE	MOTOR BRACKET	DIMENSIONS (mm)			WEIGHT (kg)	
		A	B	C	MOTOR	PUMP
8LMG 92/01-6	6" NEMA	1228	527	701	55	23
8LMG 92/02-6		1493	652	841	70	31
8LMG 92/03-6		1768	777	991	83	39
8LMG 92/04-6		2083	902	1181	100	48
8LMG 92/05-6		2278	1027	1251	108	56
8LMG 92/06-6		2493	1152	1341	118	64
8LMG 92/07	8" NEMA	2400	1277	1123	178	73
8LMG 92/08		2635	1402	1233	200	81
8LMG 92/09		2760	1527	1233	200	89
8LMG 92/10		2955	1652	1303	214	98
8LMG 92/11		3080	1777	1303	214	106
8LMG 92/12		3285	1902	1383	230	114
8LMG 92/13		3410	2027	1383	230	122
8LMG 92/14		3735	2152	1583	270	131
8LMG 92/15		3860	2277	1583	270	139



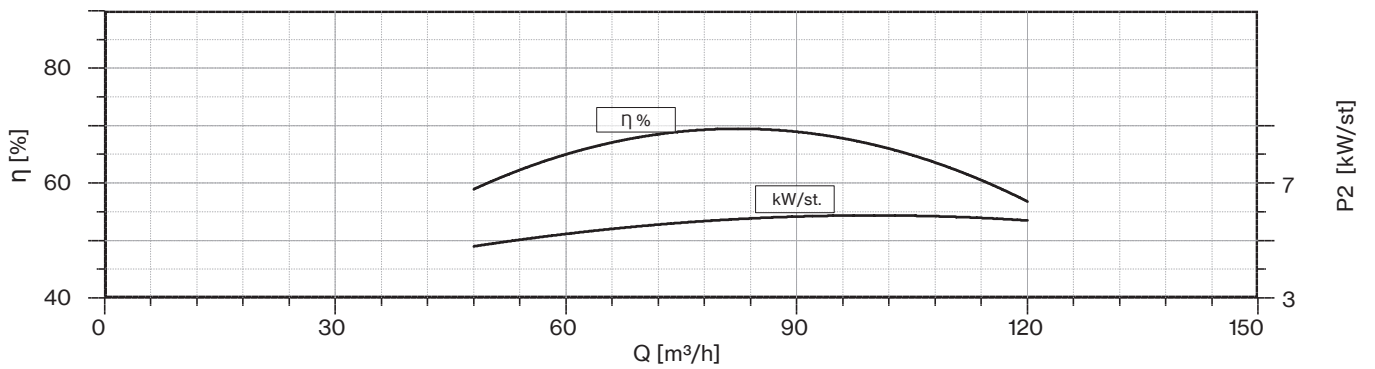
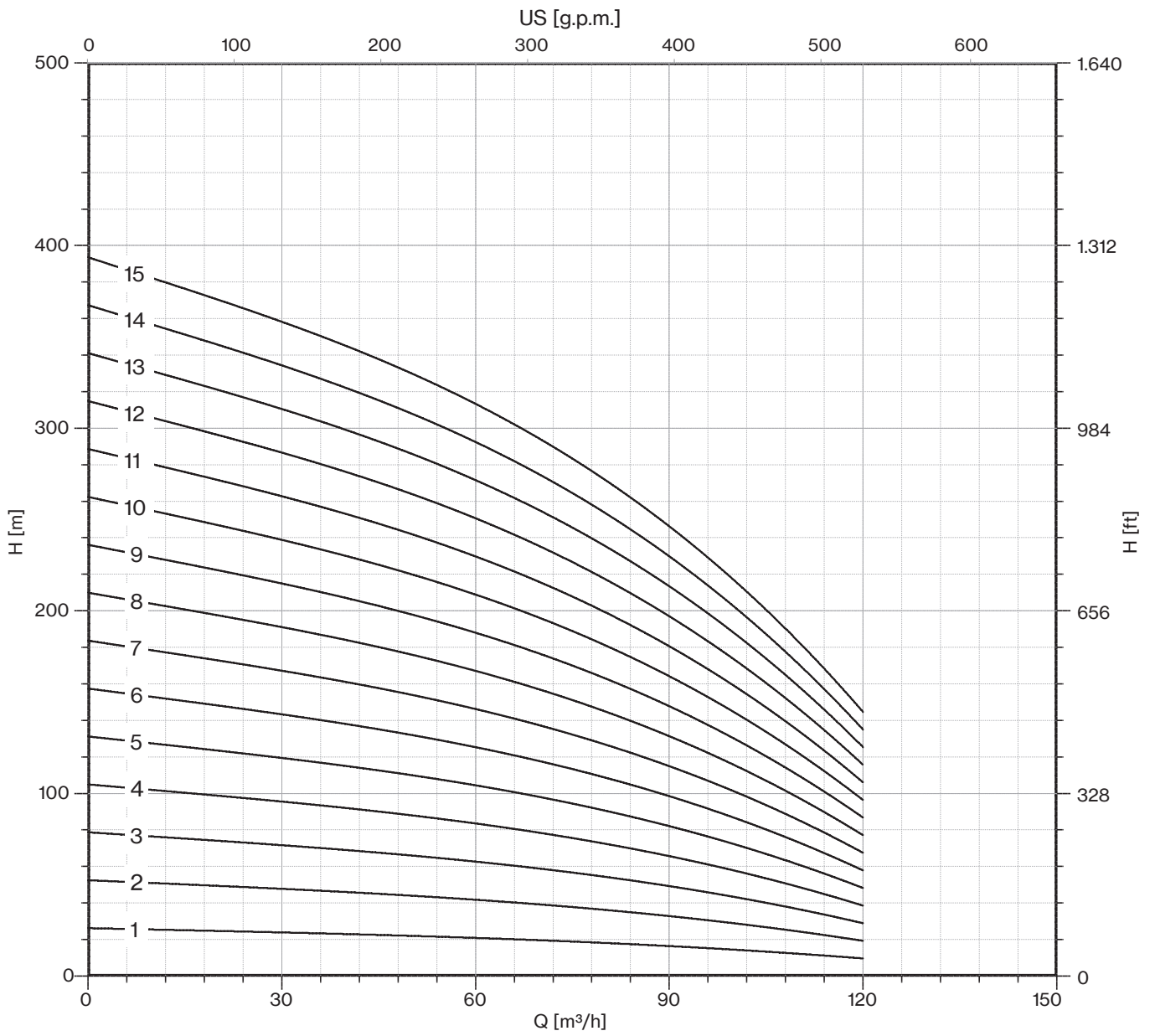

8LMG 110

50 Hz - 2900 rpm				Q									
TYPE	SUITABLE MOTOR 3- 400V		I/min	0	1000	1200	1400	1600	1800	2000	2200	2400	
	P2		CURRENT	I/sec	0	16,67	20,00	23,33	26,67	30,00	33,33	36,67	40,00
	HP	kW	A	m³/h	0	60	72	84	96	108	120	132	144
8LMG 110/01	10	7,5	17,5	H (m)	26	22	21	20	19	18	16	14	11
8LMG 110/02	20	15	32		53	44	42	40	38	35	32	28	22
8LMG 110/03	30	22	47,5		79	66	63	60	57	53	48	42	33
8LMG 110/04	40	30	62,5		105	87	84	80	76	71	65	55	45
8LMG 110/05	50	37	78		131	109	105	100	95	89	81	69	56
8LMG 110/06	60	45	92		158	131	126	120	114	106	97	83	67
8LMG 110/07	75	55	113,5		184	153	147	140	133	124	113	97	78
8LMG 110/08	90	66	134,5		210	175	168	160	152	142	129	111	89
8LMG 110/09	90	66	134,5		237	197	189	180	171	159	145	125	100
8LMG 110/10	100	75	149,5		263	219	210	200	190	177	161	139	111
8LMG 110/11	125	92	185		289	240	231	220	209	195	178	152	123
8LMG 110/12	125	92	185		315	262	252	240	228	213	194	166	134
8LMG 110/13	125	92	185		342	284	273	260	247	230	210	180	145

Max Eff. %	74
Max kW / St.	7,3

NPSH (m)	Q=25%	Q=50%	Q=75%	Q=100%
	2,5	3,5	4,5	8

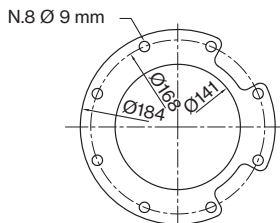
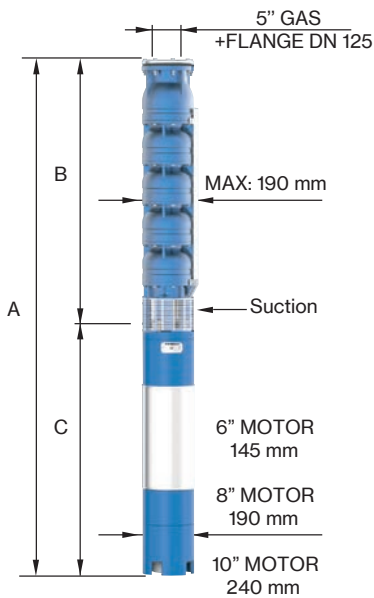

FOR COMMERCIAL TUBE
EXTERNAL DIAMETER: 139,7 mm

TYPE	MOTOR BRACKET	DIMENSIONS (mm)			WEIGHT (kg)	
		A	B	C	MOTOR	PUMP
8LMG 110/01-6	6" NEMA	1228	527	701	55	23
8LMG 110/02-6		1583	652	931	75	32
8LMG 110/03-6		1848	777	1071	92	40
8LMG 110/04-6		2153	902	1251	108	49
8LMG 110/05-6	8" NEMA	2368	1027	1341	118	58
8LMG 110/06		2275	1152	1123	178	66
8LMG 110/07		2510	1277	1233	200	75
8LMG 110/08		2705	1402	1303	214	83
8LMG 110/09		2830	1527	1303	214	92
8LMG 110/10		3035	1652	1383	230	101
8LMG 110/11		3360	1777	1583	270	109
8LMG 110/12		3485	1902	1583	270	118
8LMG 110/13	3610	2027	1583	270	126	



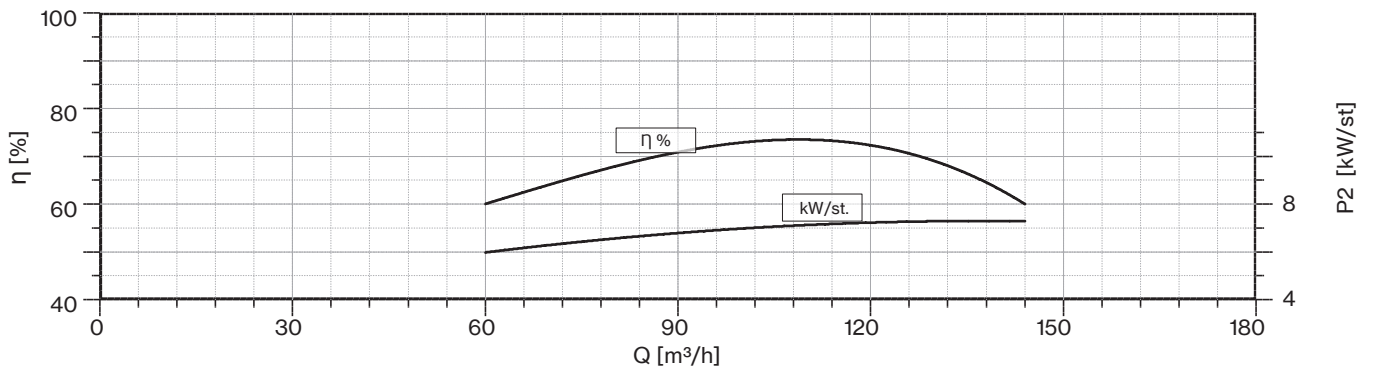
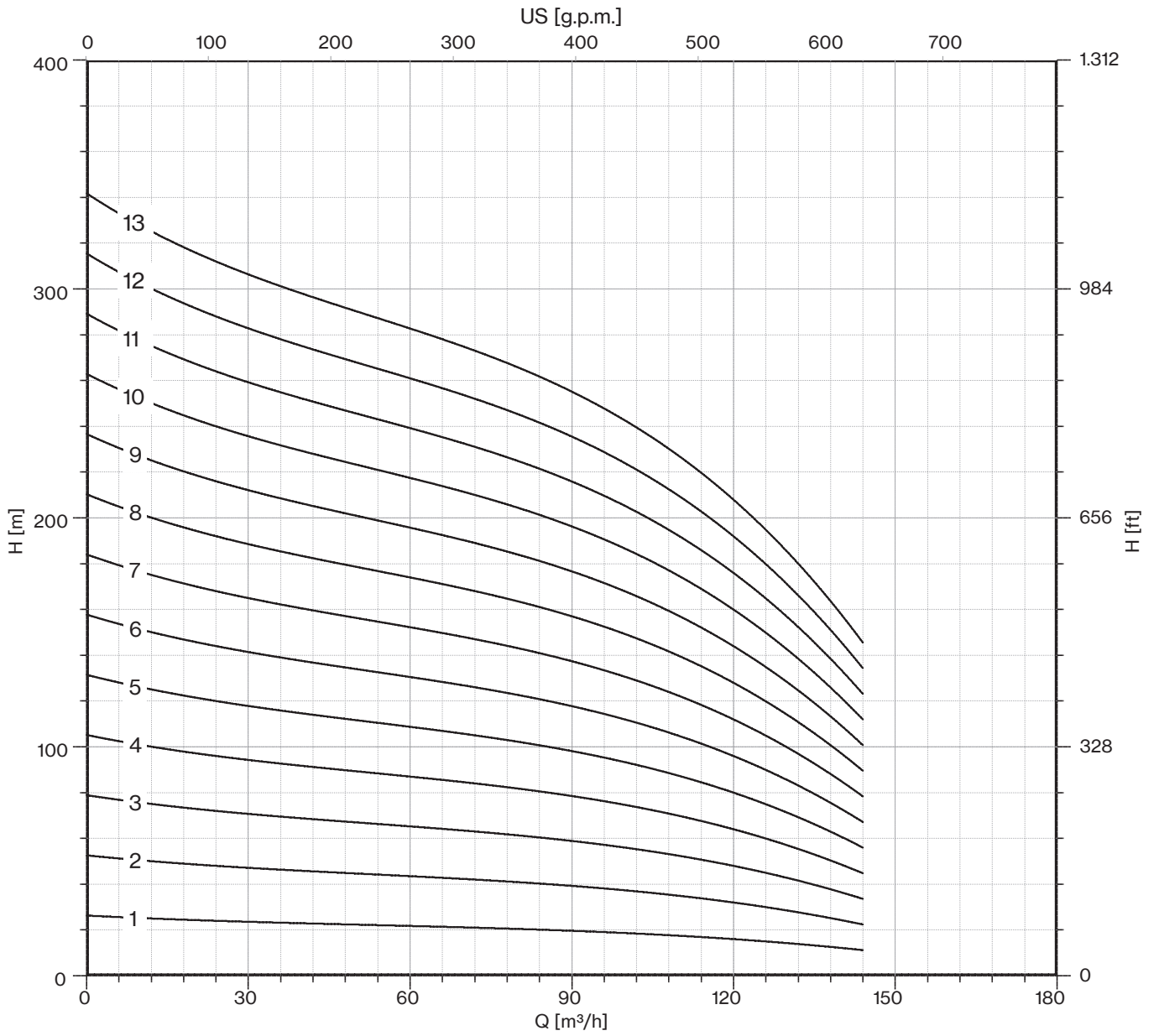

8LMG 130

50 Hz - 2900 rpm				Q										
TYPE	SUITABLE MOTOR 3- 400V		I/min	0	1200	1400	1600	1800	2000	2200	2400	2600	2800	
	P2		CURRENT	I/sec	0	20,00	23,33	26,67	30,00	33,33	36,67	40,00	43,33	46,67
	HP	kW	A	m³/h	0	72	84	96	108	120	132	144	156	168
8LMG 130/01	10	7,5	17,5	H (m)	26	21	20	19	18	17	15	13	11	8
8LMG 130/02	20	15	32		53	42	41	38	36	34	31	27	21	15
8LMG 130/03	35	26	55		79	63	61	57	54	51	46	40	32	23
8LMG 130/04	40	30	62,5		106	85	81	77	73	67	62	54	43	30
8LMG 130/05	60	45	92		132	106	101	96	91	84	77	67	54	38
8LMG 130/06	75	55	113,5		159	127	122	115	109	101	93	81	64	45
8LMG 130/07	75	55	113,5		185	148	142	134	127	118	108	94	75	53
8LMG 130/08	90	66	134,5		211	169	162	153	145	135	123	107	86	61
8LMG 130/09	100	75	149,5		238	190	183	172	163	152	139	121	96	68
8LMG 130/10	100	75	149,5		264	211	203	191	181	169	154	134	107	76
8LMG 130/11	125	92	185		291	233	223	211	200	185	170	148	118	83
8LMG 130/12	125	92	185		317	254	243	230	218	202	185	161	129	91
8LMG 130/13	150	110	219		344	275	264	249	236	219	201	175	139	98
8LMG 130/14	150	110	220		370	296	284	268	254	236	216	188	150	106

Max Eff. %	75
Max kW / St.	7,7

NPSH (m)	Q=25%	Q=50%	Q=75%	Q=100%
	2,5	3	5	9

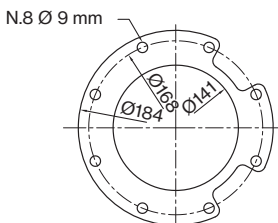
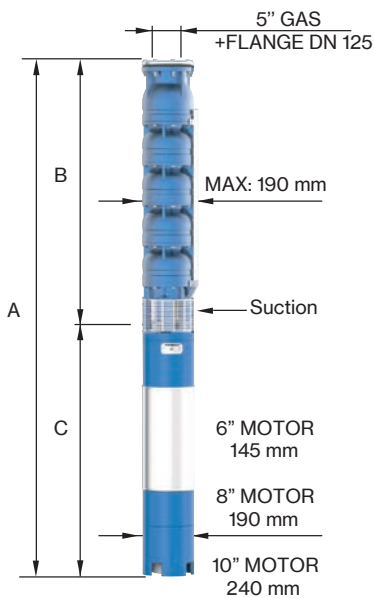

FOR COMMERCIAL TUBE
EXTERNAL DIAMETER: 139,7 mm

TYPE	MOTOR BRACKET	DIMENSIONS (mm)			WEIGHT (kg)	
		A	B	C	MOTOR	PUMP
8LMG 130/01-6	6" NEMA	1228	527	701	55	23
8LMG 130/02-6		1583	652	931	75	32
8LMG 130/03-6		1958	777	1181	100	41
8LMG 130/04-6		2153	902	1251	108	49
8LMG 130/05	8" NEMA	2150	1027	1123	178	58
8LMG 130/06		2385	1152	1233	200	67
8LMG 130/07		2510	1277	1233	200	75
8LMG 130/08		2705	1402	1303	214	84
8LMG 130/09		2910	1527	1383	230	93
8LMG 130/10		3035	1652	1383	230	102
8LMG 130/11		3360	1777	1583	270	110
8LMG 130/12		3485	1902	1583	270	119
8LMG 130/13		3760	2027	1733	300	128
8LMG 130/14		3885	2152	1733	300	136



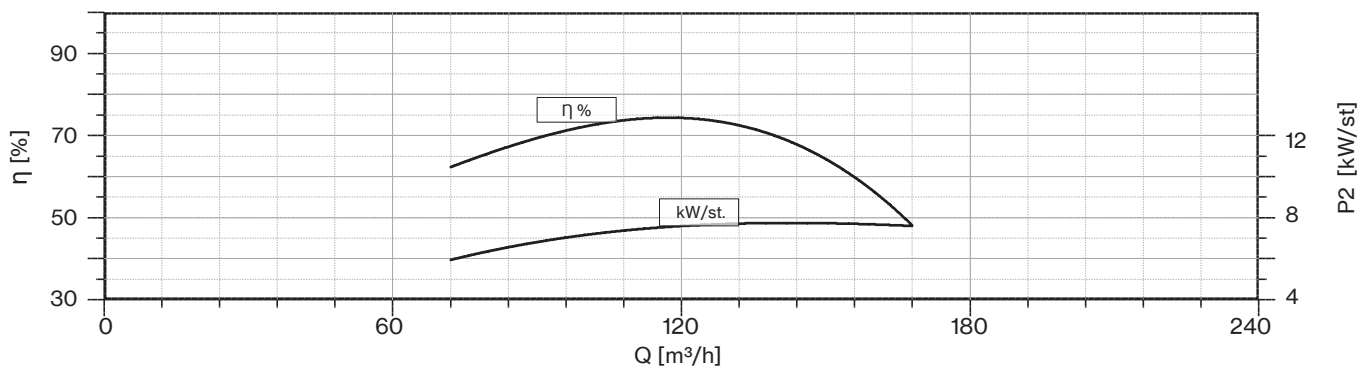
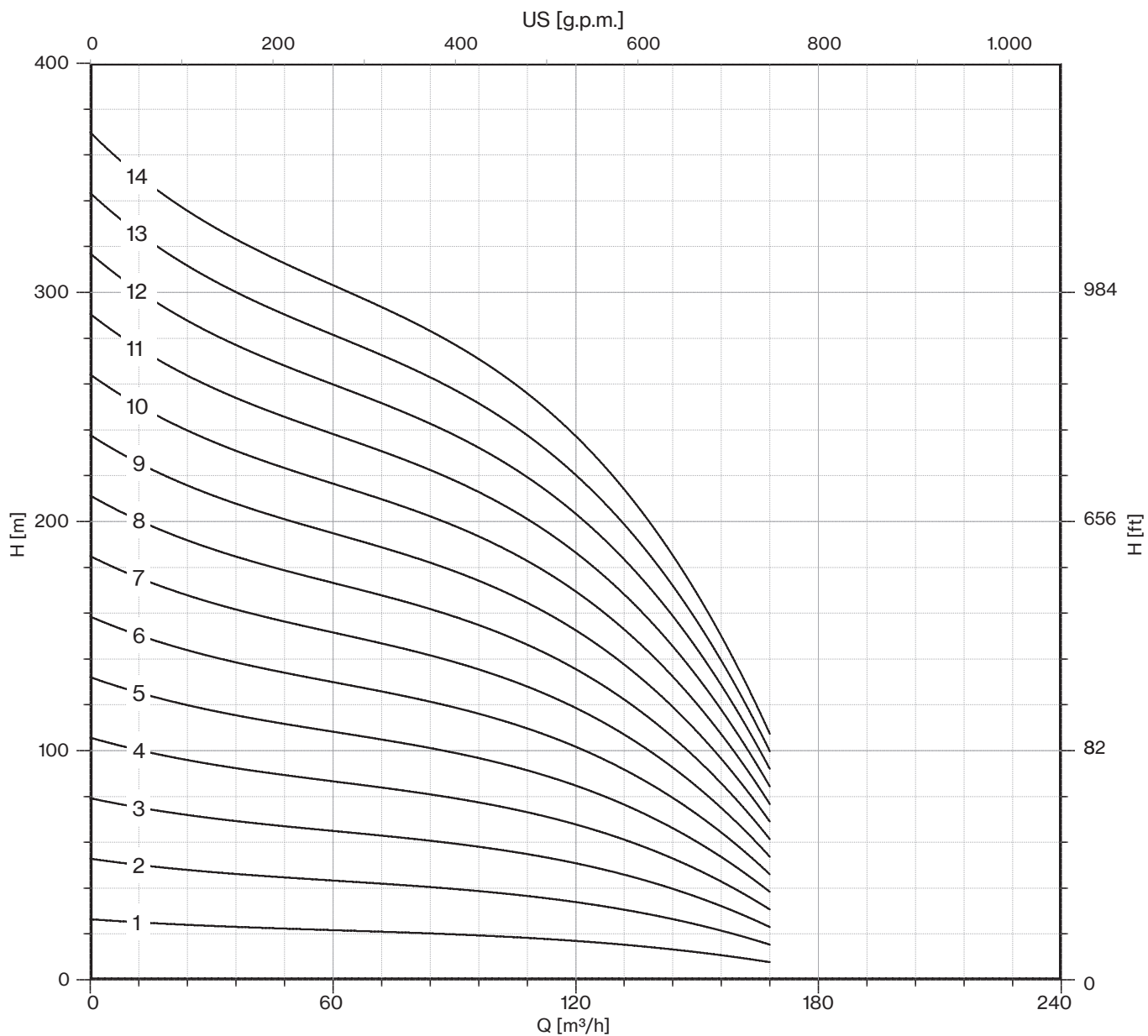

8LMG 160

50 Hz - 2900 rpm				Q										
TYPE	SUITABLE MOTOR 3- 400V		I/min	0	1600	1800	2000	2200	2400	2600	2800	3000	3200	
	P2		CURRENT	I/sec	0	26,67	30,00	33,33	36,67	40,00	43,33	46,67	50,00	53,33
	HP	kW	A	m³/h	0	96	108	120	132	144	156	168	180	192
8LMG 160/01	12,5	9,2	21	H (m)	24	19	18	17	16	16	15	13	12	10
8LMG 160/02	25	18,5	40		49	38	36	35	33	31	30	27	24	20
8LMG 160/03	35	26	55		73	57	54	52	49	47	45	40	36	30
8LMG 160/04	50	37	78		97	76	72	69	66	63	59	54	48	40
8LMG 160/05	60	45	92		121	95	90	86	82	79	74	67	60	50
8LMG 160/06	75	55	113,5		146	114	108	104	99	94	89	81	72	60
8LMG 160/07	90	66	134,5		170	133	126	121	115	110	104	94	84	70
8LMG 160/08	100	75	149,5		194	152	144	138	131	126	119	107	96	80
8LMG 160/09	100	75	149,5		219	171	162	156	148	141	134	121	108	90
8LMG 160/10	125	92	185		243	190	180	173	164	157	149	134	120	100
8LMG 160/11	125	92	185		267	209	198	190	181	173	163	148	132	110
8LMG 160/12	150	110	219		291	228	216	207	197	189	178	161	144	120
8LMG 160/13	150	110	219		316	247	234	225	214	204	193	175	156	130

Max Eff. %	74
Max kW / St.	8,6

NPSH (m)	Q=25%	Q=50%	Q=75%	Q=100%
	2,5	3	5	9

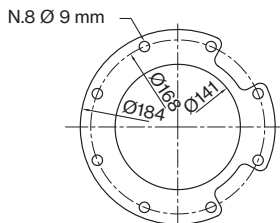
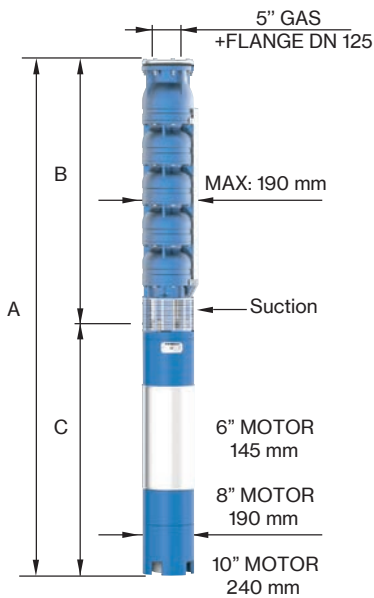

FOR COMMERCIAL TUBE
EXTERNAL DIAMETER: 139,7 mm

TYPE	MOTOR BRACKET	DIMENSIONS (mm)			WEIGHT (kg)	
		A	B	C	MOTOR	PUMP
8LMG 160/01-6	6" NEMA	1303	552	751	60	24
8LMG 160/02-6		1693	702	991	83	33
8LMG 160/03-6		2033	852	1181	100	42
8LMG 160/04-6		2343	1002	1341	118	51
8LMG 160/05	8" NEMA	2275	1152	1123	178	60
8LMG 160/06		2535	1302	1233	200	69
8LMG 160/07		2755	1452	1303	214	78
8LMG 160/08		2985	1602	1383	230	87
8LMG 160/09		3135	1752	1383	230	96
8LMG 160/10		3485	1902	1583	270	105
8LMG 160/11		3635	2052	1583	270	114
8LMG 160/12		3935	2202	1733	300	123
8LMG 160/13		4085	2352	1733	300	132



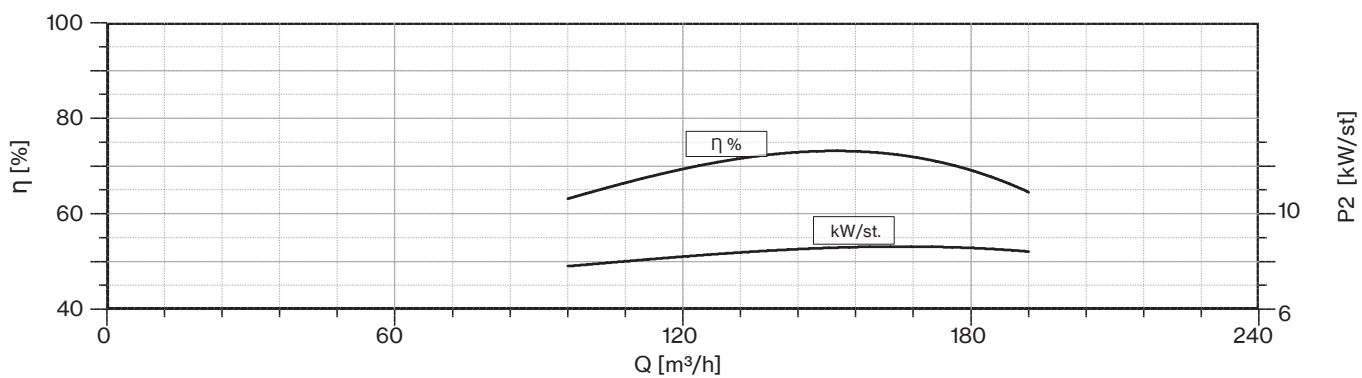
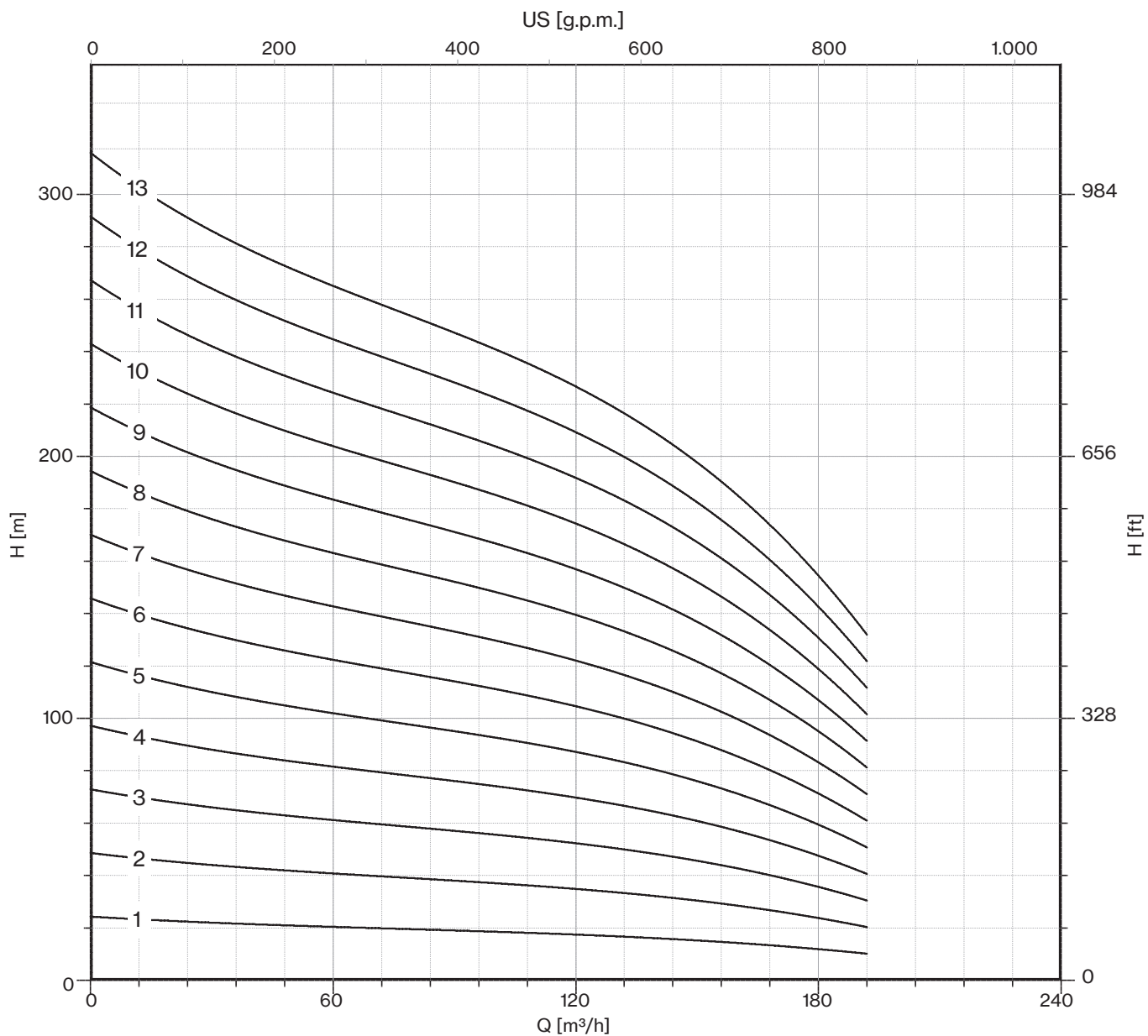

6-8-10 LMG

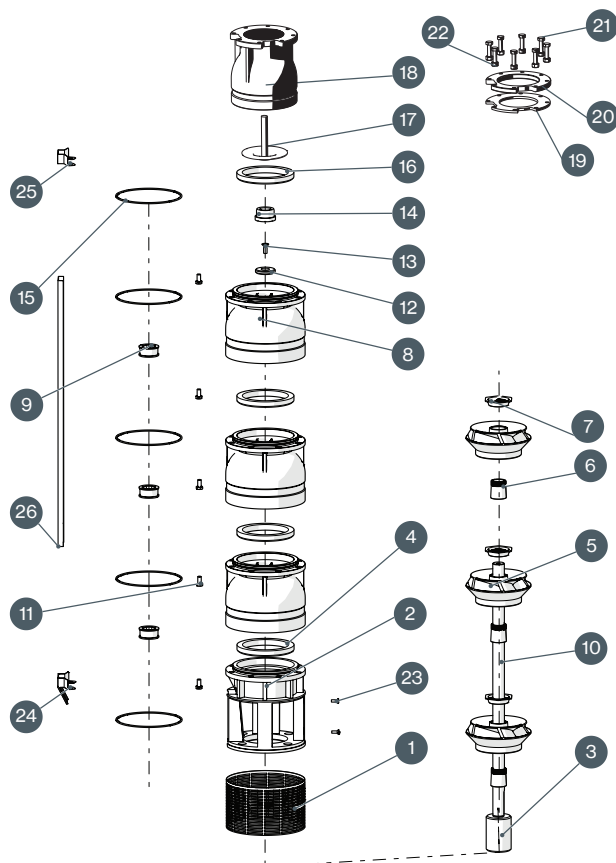

N. CODE	DESCRIPTION	MATERIAL
1	SUCTION STRAINER	AISI 304
2	SUCTION CAGE	CAST IRON
3	JOINT	AISI 304
4	USURY RING	NBR
5	IMPELLER	CAST IRON
6	CONE	AISI 304
7	HEXAGONAL RING	AISI 304
8	DIFFUSEUR	AISI 304
9	BEARING BUSH	NBR
10	PUMP SHAFT	AISI 304
11	N.8 SCREW FOR DIFFUSEUR	AISI 304
12	RING	AISI 304
13	SCREW FOR DISK	AISI 304
14	COUNTERTHRUST	PTFE + 25% CARBON
15	O-RING	NBR
16	GASKET VALVE	NBR
17	CAP VALVE	AISI 304
18	BODY VALVE	CAST IRON
19	SEAL COUNTERFLANGE	NBR
20	COUNTERFLANGE	IRON
21	N.8 SCREW FOR COUNTERFLANGE	AISI 304
22	N.8 NUT FOR COUNTERFLANGE	AISI 304
23	N.2 SCREW FOR SUCTION STRAINER	AISI 304
24	LOWER FLANGE	AISI 304
25	UPPER FLANGE	AISI 304
26	COVER CABLE	AISI 304

