

# 6-8-10LMG lines

## Deepwell Borehole



Submersible multistage centrifugal pumps for 6", 8", 10" wells. Check valve built into the delivery outlet. The motor bracket and coupling are made according to NEMA standards. Most common applications are civil and agricultural.

### Construction features

<b>Suction and delivery outlet</b>	cast iron GG25
<b>Valve</b>	stainless steel AISI 304
<b>Impellers and diffusers</b>	cast iron GG25; AISI 304 impeller on request
<b>Upper bushings</b>	NBR rubber
<b>Shaft pump side</b>	stainless steel AISI 304
<b>Quantity of sand in the water</b>	max 50 g/m <sup>3</sup>

### Motor

<b>Asynchronous 2 pole</b>	rewindable water cooled
<b>Insulation class</b>	Y (max 30 °C) - PPC winding type F (max 50 °C) - PE2+PA or LPE winding type
<b>Protection degree</b>	IP68
<b>Liquid temperature</b>	max 30 °C (max 50 °C on request)
<b>Depth of immersion</b>	max 350 m



60 Hz - 3500 rpm			Q							
TYPE	P2		l/min	0	720	960	1200	1440	1680	1920
			l/sec	0	12	16	20	24	28	32
	HP	kW	m³/h	0	43,2	57,6	72	86,4	100,8	115,2
8LMG 80/01	12,5	9,2	H (m)	38	32	30	28	25	21	16
8LMG 80/02	25	18,5		76	64	60	56	50	42	32
8LMG 80/03	35	26		113	96	91	84	76	64	49
8LMG 80/04	50	37		151	128	121	112	101	85	65
8LMG 80/05	60	44		189	160	151	140	126	106	81
8LMG 80/06	75	55		227	192	181	167	151	127	97
8LMG 80/07	90	66		265	224	212	195	176	149	113
8LMG 80/08	100	75		302	256	242	223	202	170	130
8LMG 80/09	125	92		340	288	272	251	227	191	146
8LMG 80/10	125	92		378	320	302	279	252	212	162
8LMG 80/11	150	110		416	352	333	307	277	234	178
8LMG 80/12	150	110		454	384	363	335	302	255	194

Max Eff. % =	70
Max kW / St. =	8,82

NPSH (m)	Q=25%	Q=50%	Q=75%	Q=100%
	3	3	3,5	4,5

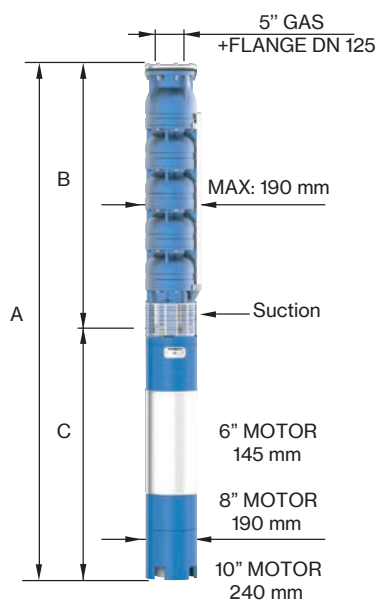

TYPE	MOTOR BRACKET	DIMENSIONS (mm)			WEIGHT (kg)	
		A	B	C	MOTOR	PUMP
8LMG 80/01-6	6" NEMA	1278	527	751	60	23
8LMG 80/02-6		1643	652	991	83	31
8LMG 80/03-6		1958	777	1181	100	39
8LMG 80/04-6		2243	902	1341	118	48
8LMG 80/05	8" NEMA	2150	1027	1123	178	56
8LMG 80/06		2385	1152	1233	200	64
8LMG 80/07		2580	1277	1303	214	73
8LMG 80/08		2785	1402	1383	230	81
8LMG 80/09		3110	1527	1583	270	89
8LMG 80/10		3235	1652	1583	270	98
8LMG 80/11		3510	1777	1733	300	106
8LMG 80/12		3635	1902	1733	300	114

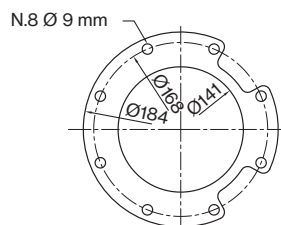

FOR COMMERCIAL TUBE  
EXTERNAL DIAMETER: 139,7 mm



# 8LMG 80

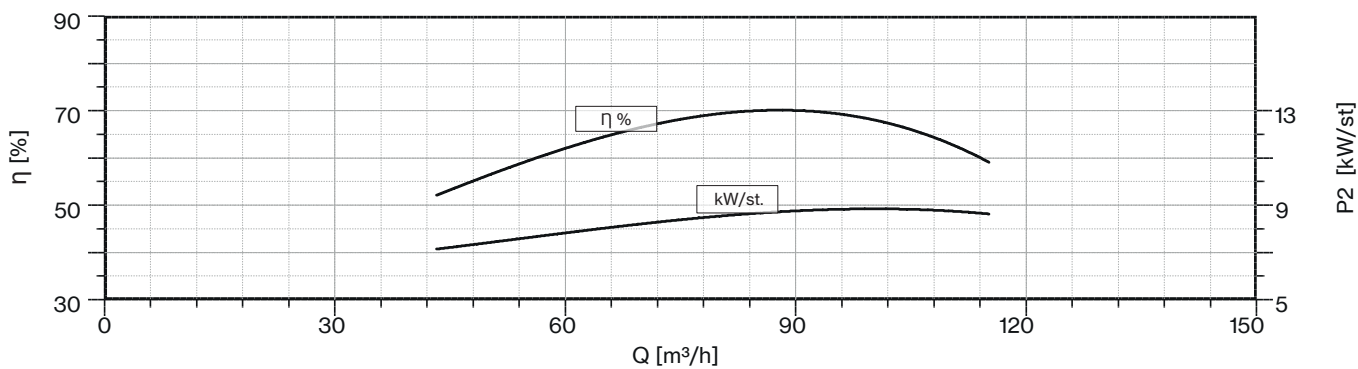
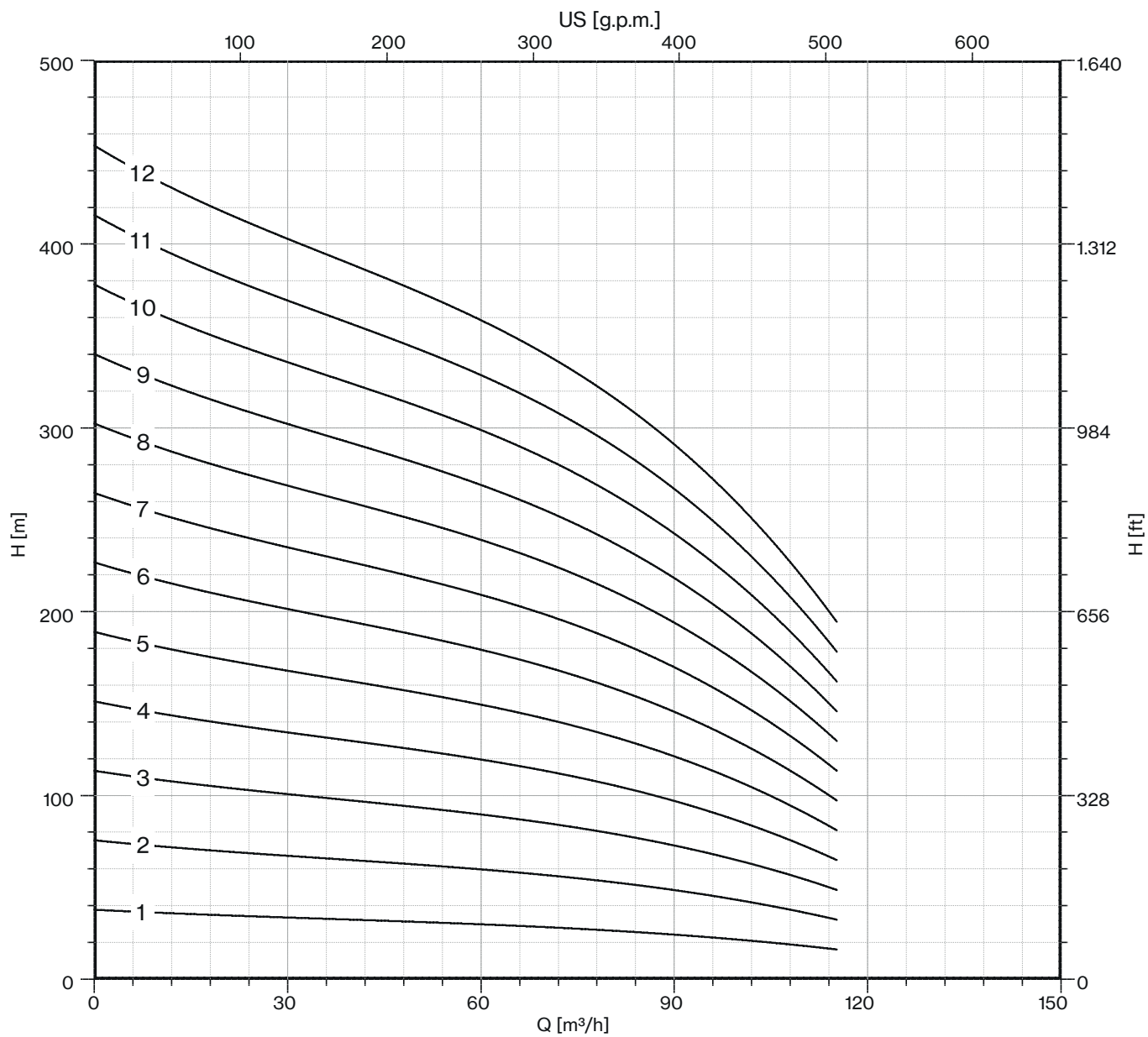

60 Hz - 3500 rpm			Q								
TYPE	P2		l/min	0	960	1200	1440	1680	1920	2160	2400
			l/sec	0	16	20	24	28	32	36	40
	HP	kW	m³/h	0	57,6	72	86,4	100,8	115,2	129,6	144
8LMG 92/01	15	11	H (m)	38	32	30	28	25	22	18	14
8LMG 92/02	30	22		76	64	60	56	50	44	36	28
8LMG 92/03	40	30		113	96	90	84	76	66	54	42
8LMG 92/04	60	45		151	127	120	112	101	88	72	56
8LMG 92/05	75	55		189	159	150	140	126	110	90	70
8LMG 92/06	90	66		227	191	180	168	151	132	108	84
8LMG 92/07	100	75		265	223	210	197	176	154	126	98
8LMG 92/08	125	92		302	255	240	225	202	176	144	112
8LMG 92/09	125	92		340	287	271	253	227	198	162	126
8LMG 92/10	150	110		378	319	301	281	252	220	180	140
8LMG 92/11	150	110		416	350	331	309	277	242	198	154

Max Eff. % =	70
Max kW / St. =	10,2

NPSH (m)	Q=25%	Q=50%	Q=75%	Q=100%
	3	4	5	8

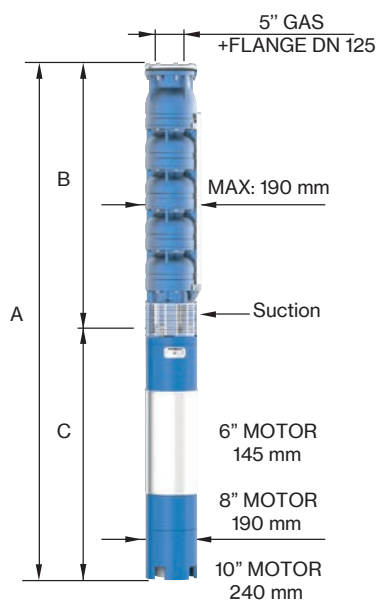

TYPE	MOTOR BRACKET	DIMENSIONS (mm)			WEIGHT (kg)	
		A	B	C	MOTOR	PUMP
8LMG 92/01-6	6" NEMA	1338	527	811	65	23
8LMG 92/02-6		1723	652	1071	92	31
8LMG 92/03-6		2028	777	1251	108	39
8LMG 92/04	8" NEMA	2025	902	1123	178	48
8LMG 92/05		2260	1027	1233	200	56
8LMG 92/06		2455	1152	1303	214	64
8LMG 92/07		2660	1277	1383	230	73
8LMG 92/08		2985	1402	1583	270	81
8LMG 92/09		3110	1527	1583	270	89
8LMG 92/10		3385	1652	1733	300	98
8LMG 92/11		3510	1777	1733	300	106

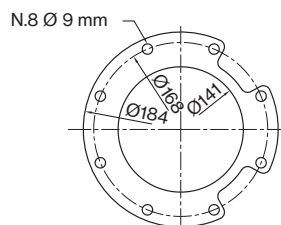

FOR COMMERCIAL TUBE  
EXTERNAL DIAMETER: 139,7 mm



# 8LMG 92

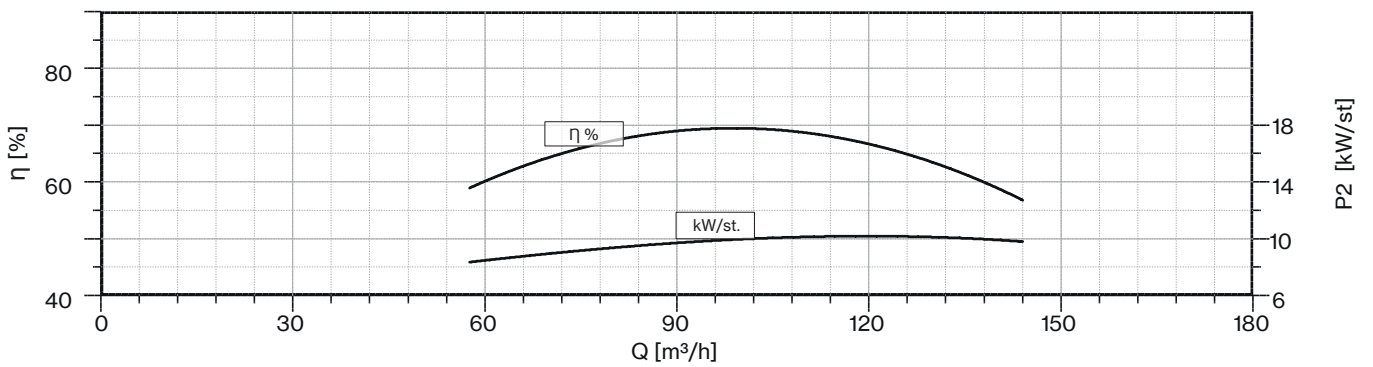
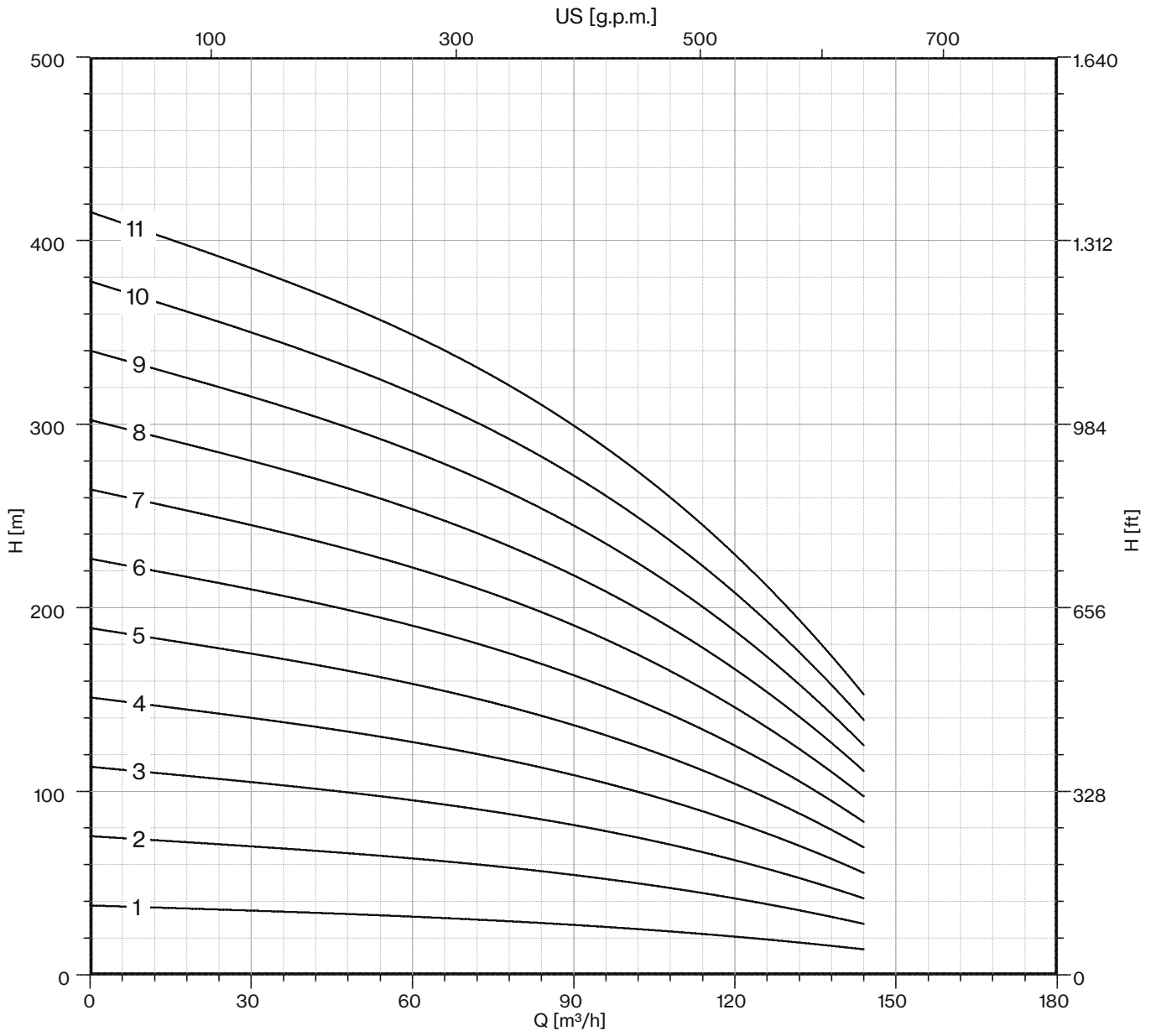

60 Hz - 3500 rpm			Q									
TYPE	P2		l/min	0	1200	1440	1680	1920	2160	2400	2640	2880
	HP	kW	l/sec	0	20	24	28	32	36	40	44	48
			m³/h	0	72	86,4	100,8	115,2	129,6	144	158,4	172,8
8LMG 110/01	17,5	13	H (m)	38	31	30	29	27	26	23	20	16
8LMG 110/02	35	26		76	63	60	58	55	51	46	40	32
8LMG 110/03	50	37		114	94	91	86	82	77	70	60	48
8LMG 110/04	75	55		151	126	121	115	109	102	93	80	64
8LMG 110/05	90	66		189	157	151	144	137	128	116	100	80
8LMG 110/06	100	75		227	189	181	173	164	153	139	120	96
8LMG 110/07	125	92		265	220	212	202	192	179	163	140	112
8LMG 110/08	150	110		303	252	242	230	219	204	186	160	128
8LMG 110/09	150	110		341	283	272	259	246	230	209	180	144

Max Eff. % =	74
Max kW / St. =	12,6

NPSH (m)	Q=25%	Q=50%	Q=75%	Q=100%
	2,5	3,5	4,5	8

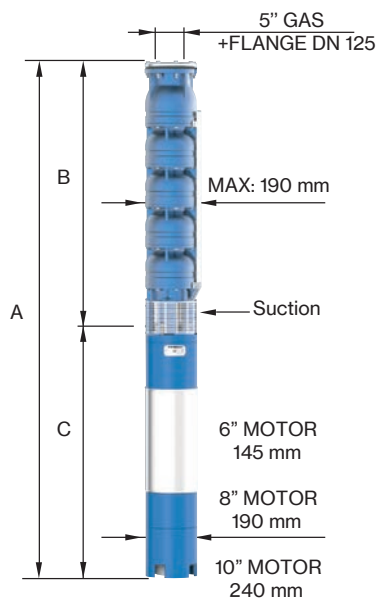

TYPE	MOTOR BRACKET	DIMENSIONS (mm)			WEIGHT (kg)	
		A	B	C	MOTOR	PUMP
8LMG 110/01-6	6" NEMA	1368	527	841	70	23
8LMG 110/02-6		1833	652	1181	100	32
8LMG 110/03-6		2118	777	1341	118	40
8LMG 110/04	8" NEMA	2135	902	1233	200	49
8LMG 110/05		2330	1027	1303	214	58
8LMG 110/06		2535	1152	1383	230	66
8LMG 110/07		2860	1277	1583	270	75
8LMG 110/08		3135	1402	1733	300	83
8LMG 110/09		3260	1527	1733	300	92

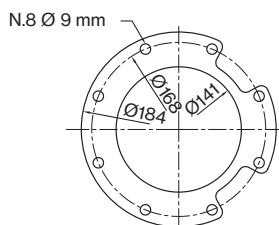

FOR COMMERCIAL TUBE  
EXTERNAL DIAMETER: 139,7 mm



# 8LMG 110

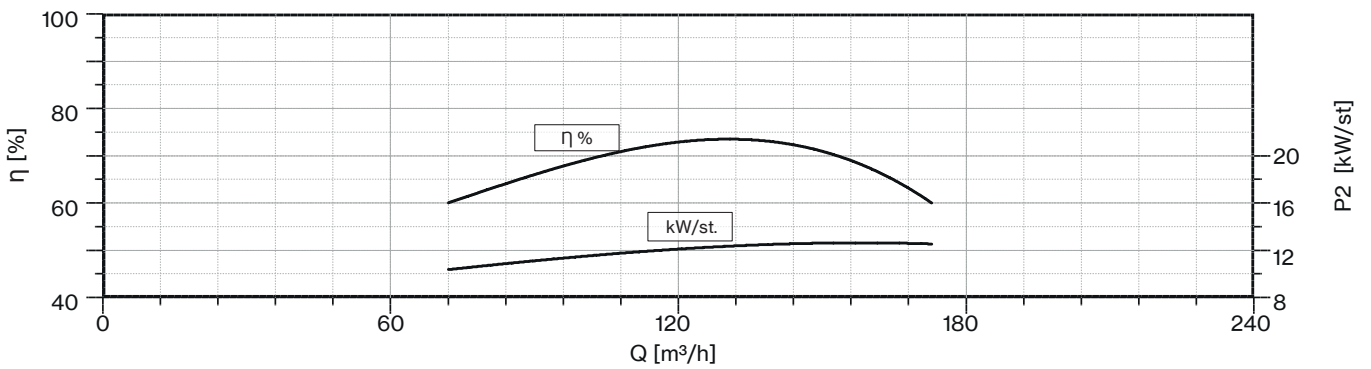
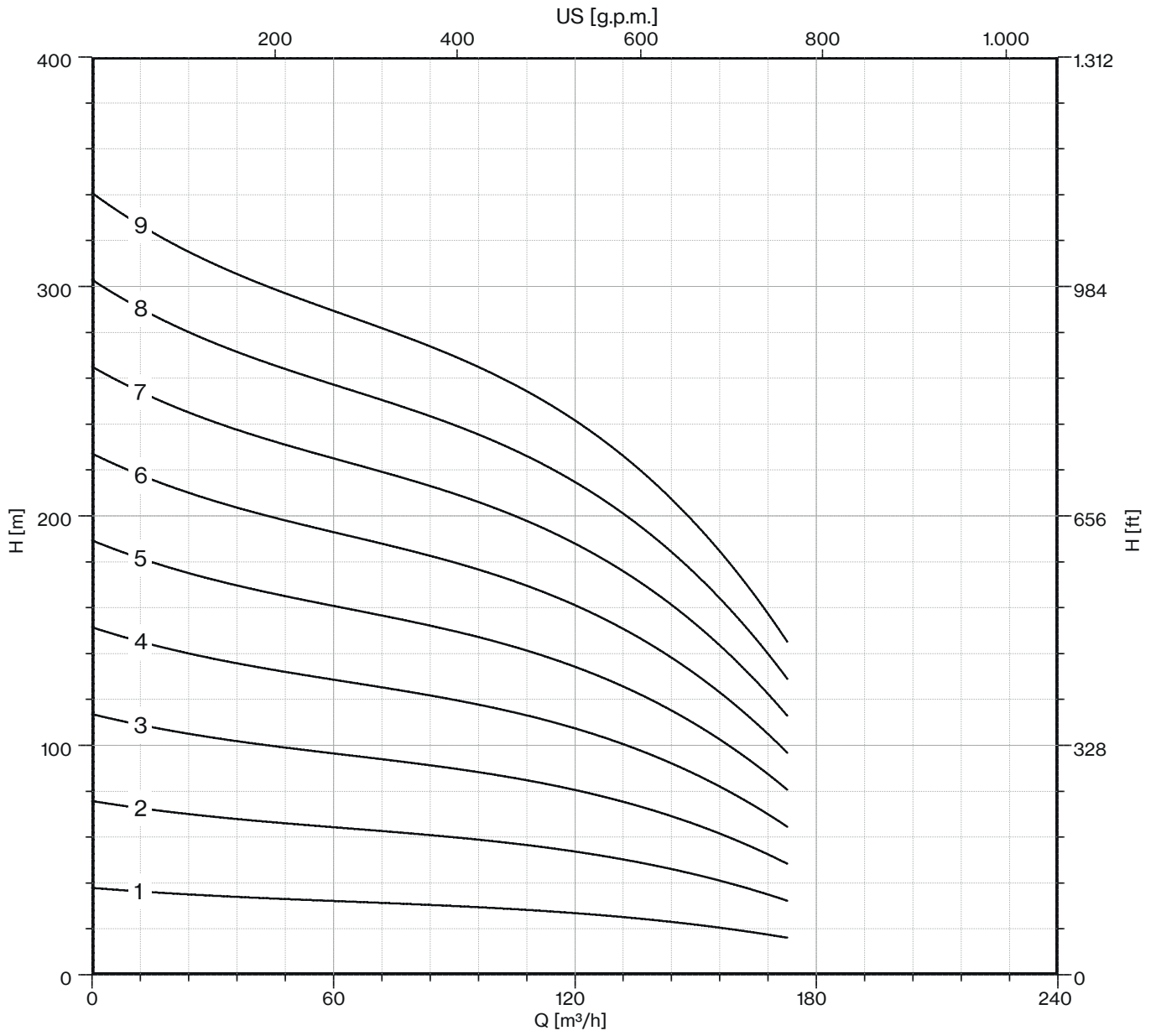

60 Hz - 3500 rpm			Q										
TYPE	P2		l/min	0	1440	1680	1920	2160	2400	2640	2880	3120	3360
			l/sec	0	24	28	32	36	40	44	48	52	56
	HP	kW	m <sup>3</sup> /h	0	86,4	100,8	115,2	129,6	144	158,4	172,8	187,2	201,6
8LMG 130/01	17,5	13	H (m)	38	30	29	28	26	24	22	19	15	11
8LMG 130/02	35	26		76	61	58	55	52	49	44	39	31	22
8LMG 130/03	60	45		114	91	88	83	78	73	67	58	46	33
8LMG 130/04	75	55		152	122	117	110	105	97	89	77	62	44
8LMG 130/05	90	66		190	152	146	138	131	121	111	97	77	55
8LMG 130/06	125	92		228	183	175	165	157	146	133	116	93	65
8LMG 130/07	125	92		266	213	204	193	183	170	156	135	108	76
8LMG 130/08	150	110		304	244	234	221	209	194	178	155	123	87

Max Eff. % =	75
Max kW / St. =	13,3

NPSH (m)	Q=25%	Q=50%	Q=75%	Q=100%
	2,5	3	5	9

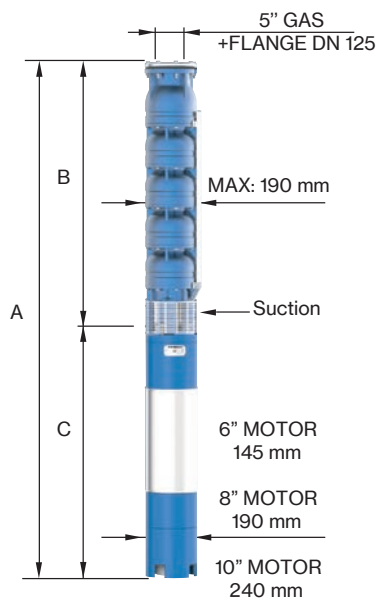

TYPE	MOTOR BRACKET	DIMENSIONS (mm)			WEIGHT (kg)	
		A	B	C	MOTOR	PUMP
8LMG 130/01-6	6" NEMA	1368	527	841	70	23
8LMG 130/02-6		1833	652	1181	100	32
8LMG 130/03	8" NEMA	1900	777	1123	178	41
8LMG 130/04		2135	902	1233	200	49
8LMG 130/05		2330	1027	1303	214	58
8LMG 130/06		2735	1152	1583	270	67
8LMG 130/07		2860	1277	1583	270	75
8LMG 130/08		3135	1402	1733	300	84

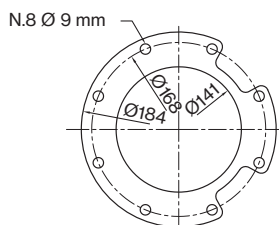

FOR COMMERCIAL TUBE  
EXTERNAL DIAMETER: 139,7 mm



# 8LMG 130

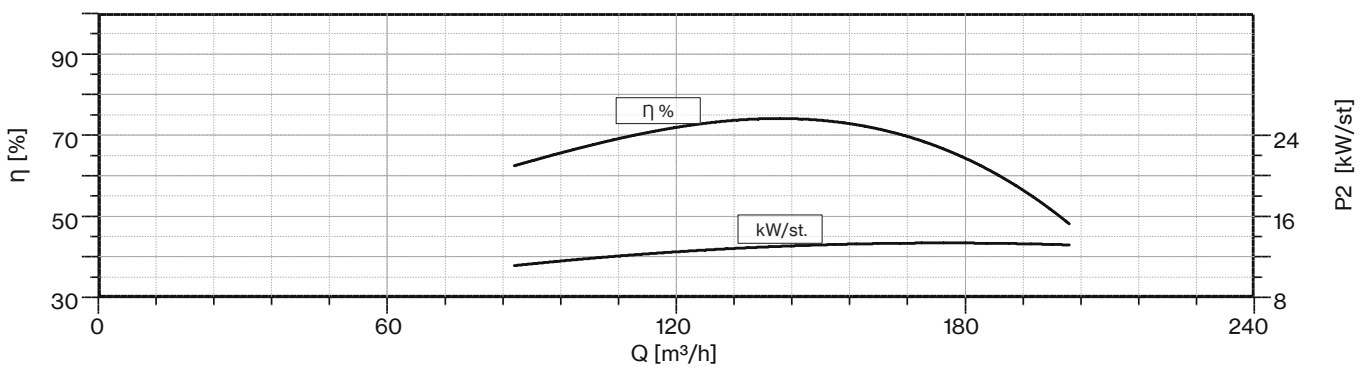
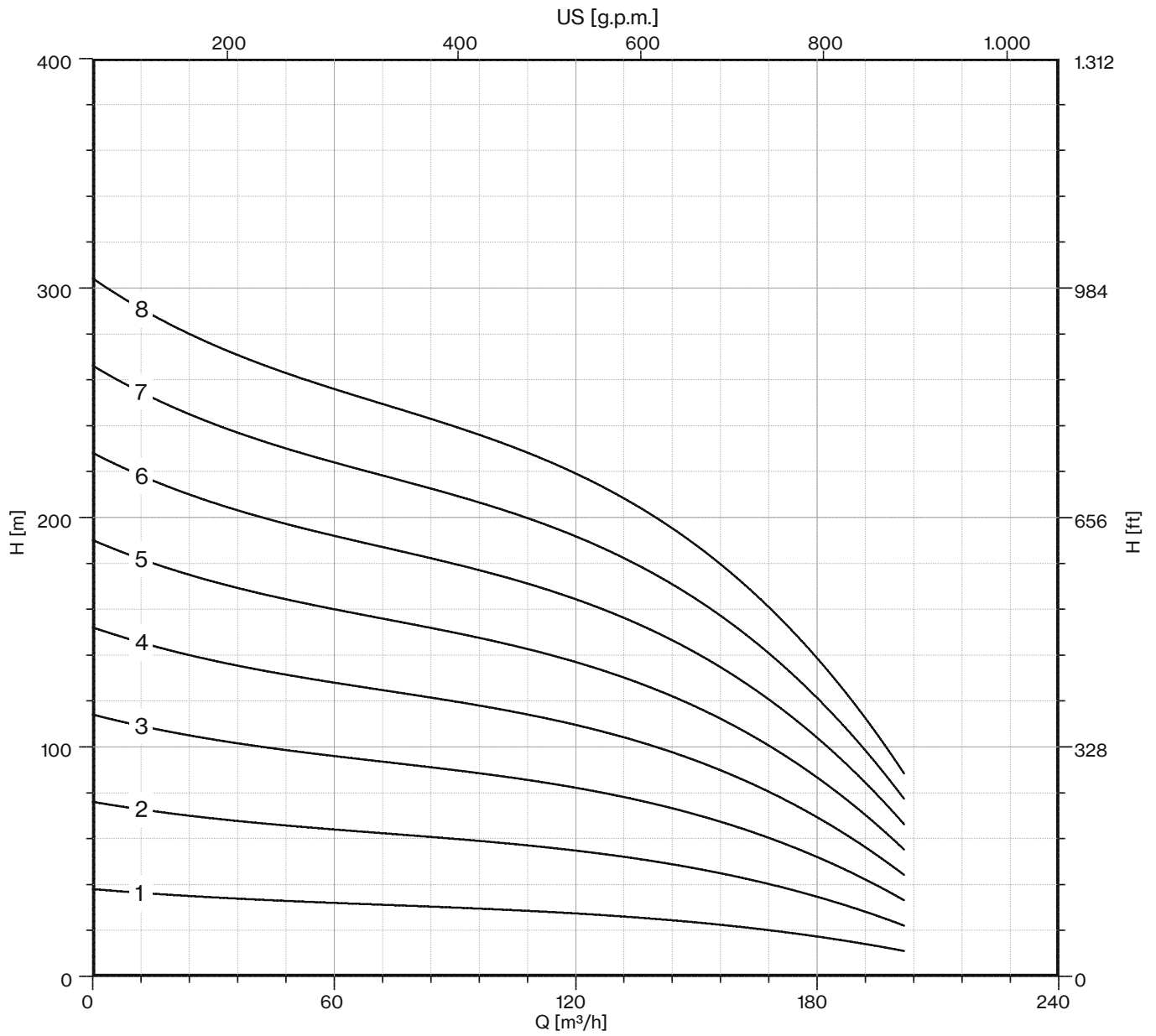

60 Hz - 3500 rpm			Q										
TYPE	P2		l/min	0	1920	2160	2400	2640	2880	3120	3360	3600	3840
			l/sec	0	32	36	40	44	48	52	56	60	64
	HP	kW	m³/h	0	115,2	129,6	144	158,4	172,8	187,2	201,6	216	230,4
8LMG 160/01	20	15	H (m)	35	27	26	25	24	23	21	19	17	14
8LMG 160/02	40	30		70	55	52	50	47	45	43	39	35	29
8LMG 160/03	60	45		105	82	78	75	71	68	64	58	52	43
8LMG 160/04	90	66		140	109	104	100	95	91	86	77	69	58
8LMG 160/05	100	75		175	137	130	124	118	113	107	97	86	72
8LMG 160/06	125	92		210	164	156	149	142	136	128	116	104	86
8LMG 160/07	150	110		245	192	181	174	166	158	150	135	121	101

Max Eff. % =	74
Max kW / St. =	14,9

NPSH (m)	Q=25%	Q=50%	Q=75%	Q=100%
	4	4,5	7	13

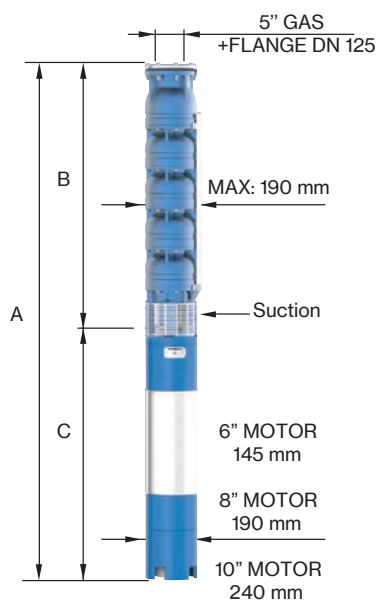

TYPE	MOTOR BRACKET	DIMENSIONS (mm)			WEIGHT (kg)	
		A	B	C	MOTOR	PUMP
8LMG 160/01-6	6" NEMA	1483	552	931	75	24
8LMG 160/02-6		1953	702	1251	108	33
8LMG 160/03	8" NEMA	1975	852	1123	178	42
8LMG 160/04		2305	1002	1303	214	51
8LMG 160/05		2535	1152	1383	230	60
8LMG 160/06		2885	1302	1583	270	69
8LMG 160/07		3185	1452	1733	300	78

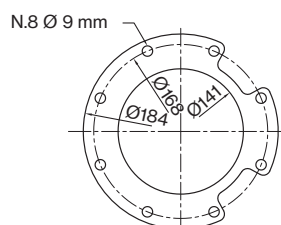

FOR COMMERCIAL TUBE  
EXTERNAL DIAMETER: 139,7 mm



# 8LMG 160

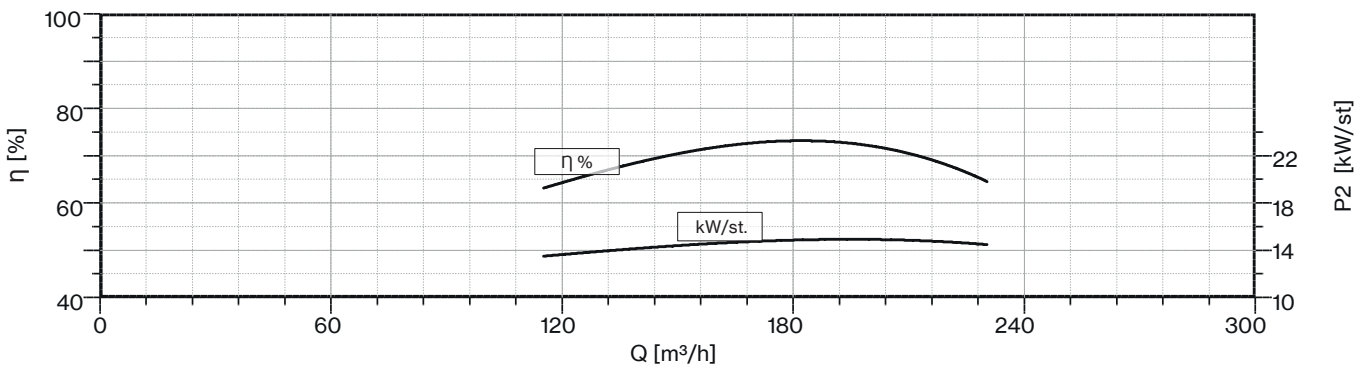
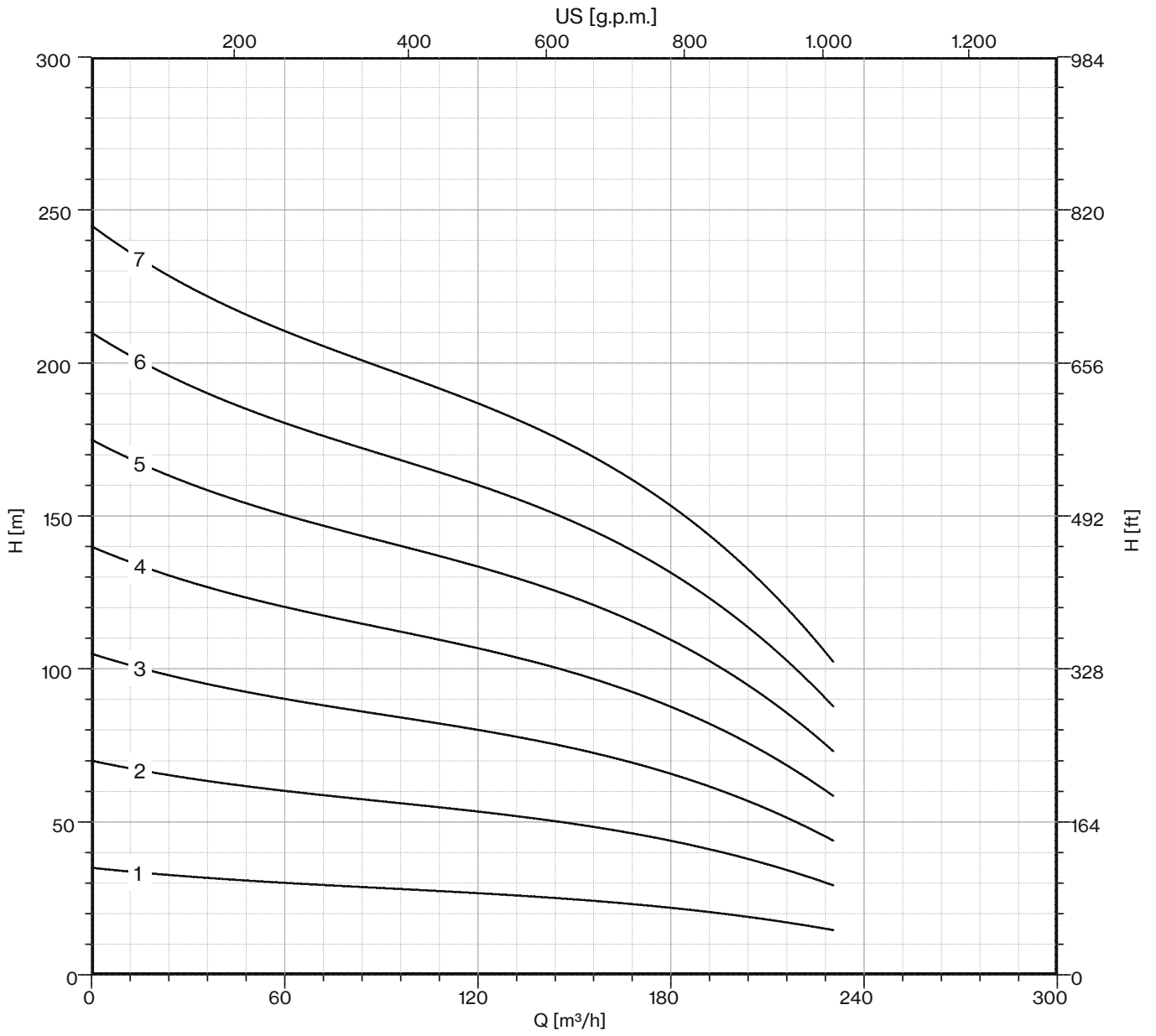

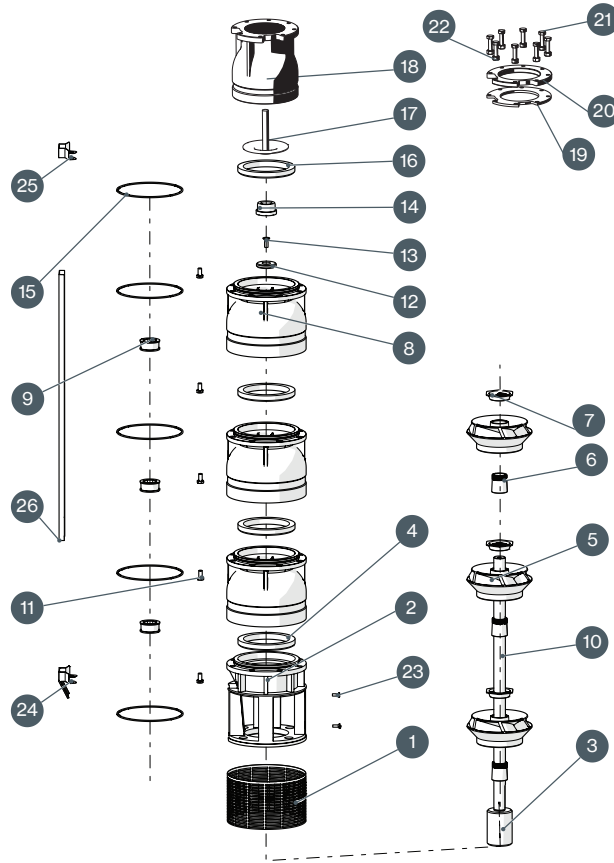

N. CODE	DESCRIPTION	MATERIAL
1	SUCTION STRAINER	AISI 304
2	SUCTION CAGE	CAST IRON
3	JOINT	AISI 304
4	USURY RING	NBR
5	IMPELLER	CAST IRON
6	CONE	AISI 304
7	HEXAGONAL RING	AISI 304
8	DIFFUSEUR	AISI 304
9	BEARING BUSH	NBR
10	PUMP SHAFT	AISI 304
11	N.8 SCREW FOR DIFFUSEUR	AISI 304
12	RING	AISI 304
13	SCREW FOR DISK	AISI 304
14	COUNTERTHRUST	PTFE + 25% CARBON
15	O-RING	NBR
16	GASKET VALVE	NBR
17	CAP VALVE	AISI 304
18	BODY VALVE	CAST IRON
19	SEAL COUNTERFLANGE	NBR
20	COUNTERFLANGE	IRON
21	N.8 SCREW FOR COUNTERFLANGE	AISI 304
22	N.8 NUT FOR COUNTERFLANGE	AISI 304
23	N.2 SCREW FOR SUCTION STRAINER	AISI 304
24	LOWER FLANGE	AISI 304
25	UPPER FLANGE	AISI 304
26	COVER CABLE	AISI 304