

10-12LM & E14 lines

Deepwell Borehole

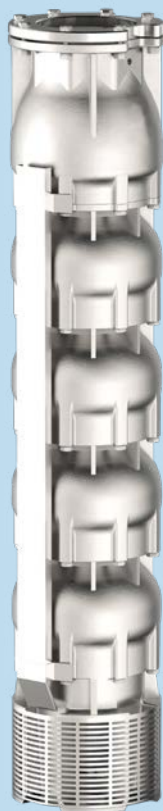

10LM line



12LM line



E14

Submersible Multistage Centrifugal Pumps for 10", 12", and 14" Wells.

These pumps are equipped with a check valve integrated into the delivery outlet. The pump motor bracket and coupling are designed in accordance with NEMA standards, ensuring reliability and compatibility.

Common applications include civil and agricultural uses. All components are manufactured from stainless steel using lost wax microfusion technology. The standard material is AISI 304 stainless steel, with the following materials available upon request: AISI 316 stainless steel, Duplex steel (EN 1.4462), and AISI 904L stainless steel.

The bushing bearings and wear rings are made from sand abrasion-resistant rubber, while the reverse-thrust ring is constructed from PTFE/Graphite for enhanced durability and performance.

General operating data:

- Capacity up to 1.000 m³/h
- Pressure up to 389 m
- Hydraulic efficiency 10", up to 79,3%
- Hydraulic efficiency 12", up to 82,5%
- Hydraulic efficiency 14", up to 82,3%
- Powers up to 400 kW
- Rotation speed 3.600 rpm
- Maximum depth: 350 m
- Maximum quantity of sand: 100 gr/m³
- Drinking water compatibility according to DM174 MEI $\geq 0,4$ (EU directive No.547/2012)
- Performance tolerance: ISO9906-3B.

Construction features

| | |
|--------------------------------------|---|
| Suction and delivery outlet | stainless steel AISI 304 (LMS) stainless steel AISI 316 (LMX - EX) Duplex EN 1.4462 (LMD - ED) Cast iron (E) |
| Valve | stainless steel AISI 304 (LMS) stainless steel AISI 316 (LMX - EX) Duplex EN 1.4462 (LMD - ED) Cast iron (E) |
| Impellers and diffusers | stainless steel AISI 304 (LMS) stainless steel AISI 316 (LMX - EX) Duplex EN 1.4462 (LMD - ED) Cast iron (E) |
| Upper bushings | NBR rubber |
| Shaft pump side | stainless steel AISI 304 (LMS) stainless steel AISI 316 (LMX) Duplex EN 1.4462 (LMD) AISI 431 (E - EX - ED) |
| Quantity of sand in the water | max 100 g/m ³ |

Motor

| | |
|----------------------------|--|
| Asynchronous 2 pole | rewindable water cooled |
| Insulation class | Y (max 30 °C) - PPC winding type F (max 50 °C) - PE2+PA or LPE winding type |
| Protection degree | IP68 |
| Liquid temperature | max 30 °C (max 50 °C on request) |
| Depth of immersion | max 350 m |



| 60 Hz - 3500 rpm | | | | Q | | | | | | | | | |
|------------------|-----|-----|-------|-------------------|-------|-------|-------|-------|-------|-------|-------|-------|-------|
| TYPE | P2 | | 400 V | l/min | 0 | 1600 | 3200 | 4800 | 6400 | 8000 | 9600 | 10200 | 11600 |
| | HP | kW | | A | l/sec | 0 | 27 | 53 | 80 | 107 | 133 | 160 | 170 |
| | | | | m ³ /h | 0 | 96 | 192 | 288 | 384 | 480 | 576 | 612 | 696 |
| E14 A/1D | 175 | 130 | 245,3 | H (m) | 103,3 | 95,8 | 90,0 | 84,5 | 78,3 | 70,6 | 59,9 | 55,0 | |
| E14 A/1C | 175 | 130 | 245,3 | | 110,6 | 103,2 | 97,2 | 91,9 | 85,8 | 78,6 | 69,0 | 64,8 | 56,2 |
| E14 A/1B | 225 | 165 | 313,3 | | 122,5 | 115,1 | 108,9 | 103,4 | 97,6 | 91,1 | 83,1 | 79,3 | 69,4 |
| E14 A/1A | 300 | 220 | 424,0 | | 139,9 | 130,8 | 123,1 | 115,8 | 108,9 | 101,8 | 94,2 | 90,7 | 82,9 |
| E14 A/1 | 300 | 220 | 424,0 | | 156,4 | 143,0 | 132,9 | 125,3 | 118,8 | 112,3 | 105,1 | 102,0 | 92,3 |
| E14 A/2D | 340 | 250 | 481,0 | | 206,6 | 191,5 | 180,0 | 169,1 | 156,7 | 141,1 | 119,8 | 110,0 | |
| E14 A/2C | 400 | 300 | 575,0 | | 221,2 | 206,5 | 194,4 | 183,7 | 171,5 | 157,1 | 138,0 | 129,6 | 112,3 |
| E14 A/2B | 450 | 330 | 620,0 | | 245,0 | 230,1 | 217,7 | 206,8 | 195,3 | 182,2 | 166,2 | 158,7 | 138,8 |
| E14 A/2A | 550 | 400 | 798,0 | | 279,7 | 261,5 | 246,2 | 231,6 | 217,7 | 203,6 | 188,4 | 181,4 | 165,9 |

| | |
|-----------------------------|-------|
| Max Eff. % = | 82,3 |
| Max KW / St. D (230mm) = | 112,3 |
| Max KW / St. C (238mm) = | 128,0 |
| Max KW / St. B (251mm) = | 157,1 |
| Max KW / St. A (268mm) = | 188,7 |
| Max KW / St. Nom. (276mm) = | 206,3 |

| NPSH (m) | Q=25% | Q=50% | Q=75% | Q=100% |
|----------|-------|-------|-------|--------|
| | 5,8 | 6,4 | 9,4 | 15,3 |

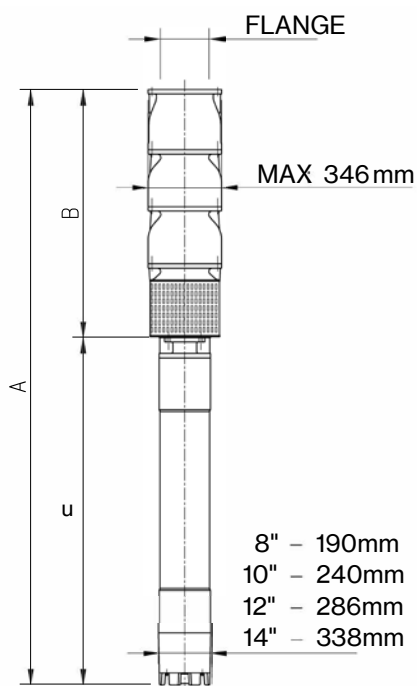

| TYPE | MOTOR BRACKET | DIMENSIONS (mm) | | | WEIGHT (kg) | |
|-------------|---------------|-----------------|------|------|-------------|------|
| | | A | B | C | MOTOR | PUMP |
| E14 A/1D-10 | 10" | 2569 | 935 | 1634 | 385 | 184 |
| E14 A/1C-10 | | 2569 | 935 | 1634 | 385 | 184 |
| E14 A/1B-10 | | 2789 | 935 | 1854 | 444 | 184 |
| E14 A/1A-12 | 12" | 3045 | 935 | 2110 | 700 | 184 |
| E14 A/1-12 | | 3045 | 935 | 2110 | 700 | 184 |
| E14 A/2D-12 | 14" | 3455 | 1175 | 2280 | 775 | 260 |
| E14 A/2C | | 3455 | 1175 | 2280 | 775 | 260 |
| E14 A/2B | | 3335 | 1175 | 2160 | 906 | 260 |
| E14 A/2A | | 3635 | 1175 | 2460 | 1105 | 260 |

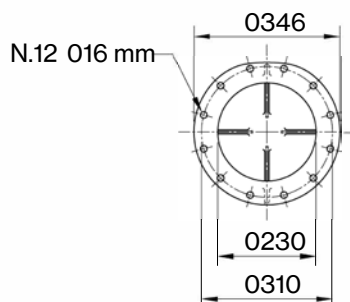

"D" Pump shaft in Duplex EN 1.4462



| 60 Hz - 3500 rpm | | | | Q | | | | | | | | | |
|------------------|-----|-----|-------|----------|-------|-------|-------------------|-------|-------|-------|-------|-------|-------|
| TYPE | P2 | | 400 V | l/min | 0 | 1600 | 4800 | 6400 | 8000 | 10800 | 12000 | 15000 | 17200 |
| | HP | kW | | A | l/sec | 0 | 26,7 | 80 | 106,7 | 133,3 | 180 | 200 | 250 |
| | | | | | | | m ³ /h | 0 | 96 | 288 | 384 | 480 | 648 |
| E14 B/1C | 225 | 165 | 313,3 | H (m) | 105,8 | 104,4 | 97,9 | 91,4 | 83,2 | 63,4 | 52,6 | 20,2 | |
| E14 B/1B | 300 | 220 | 424,0 | | 115,7 | 114,5 | 108,0 | 103,0 | 95,0 | 77,0 | 67,2 | 38,2 | |
| E14 B/1A | 340 | 250 | 481,0 | | 125,3 | 121,0 | 113,8 | 110,9 | 106,3 | 95,0 | 88,6 | 65,5 | 41,8 |
| E14 B/1 | 400 | 300 | 575,0 | | 145,2 | 140,3 | 130,2 | 125,1 | 119,4 | 106,8 | 99,4 | 77,6 | 55,3 |
| E14 B/2C | 450 | 330 | 620,0 | | 211,7 | 208,8 | 195,8 | 182,9 | 166,5 | 126,7 | 105,1 | 40,3 | |
| E14 B/2B | 550 | 400 | 798,0 | | 231,5 | 229,0 | 216,0 | 205,9 | 190,1 | 154,1 | 134,5 | 76,3 | |

| | |
|-----------------------------|-------|
| Max Eff. % = | 78,6 |
| Max KW / St. C (240mm) = | 158,8 |
| Max KW / St. B (250mm) = | 189,8 |
| Max KW / St. A (259mm) = | 224,2 |
| Max KW / St. Nom. (274mm) = | 258,8 |

| NPSH (m) | Q=25% | Q=50% | Q=75% | Q=100% |
|----------|-------|-------|-------|--------|
| 6 | 6,4 | 8,6 | 16,3 | |

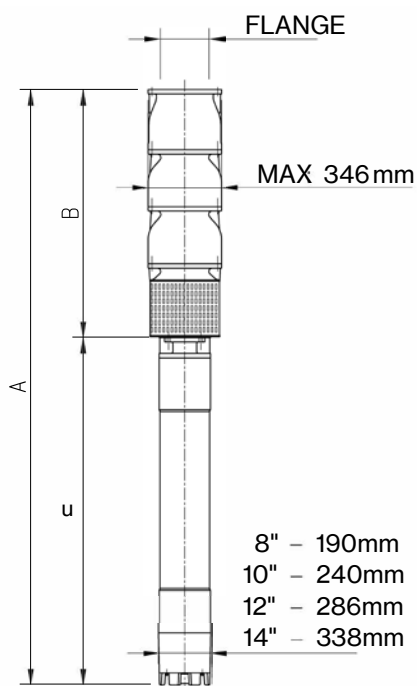

| TYPE | MOTOR BRACKET | DIMENSIONS (mm) | | | WEIGHT (kg) | |
|-------------|---------------|-----------------|------|------|-------------|------|
| | | A | B | C | MOTOR | PUMP |
| E14 B/1C-10 | 10" | 2759 | 905 | 1854 | 444 | 184 |
| E14 B/1B-12 | 12" | 3015 | 905 | 2110 | 700 | 184 |
| E14 B/1A-12 | 12" | 3185 | 905 | 2280 | 775 | 184 |
| E14 B/1 | 14" | 3185 | 905 | 2280 | 775 | 184 |
| E14 B/2C | 14" | 3335 | 1175 | 2160 | 906 | 260 |
| E14 B/2B | 14" | 3635 | 1175 | 2460 | 1105 | 260 |

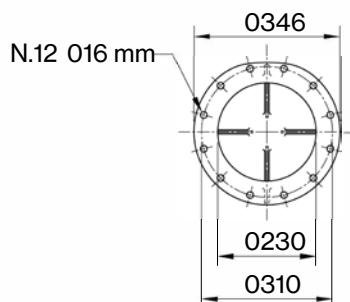

"D" Pump shaft in Duplex EN 1.4462



E14 B

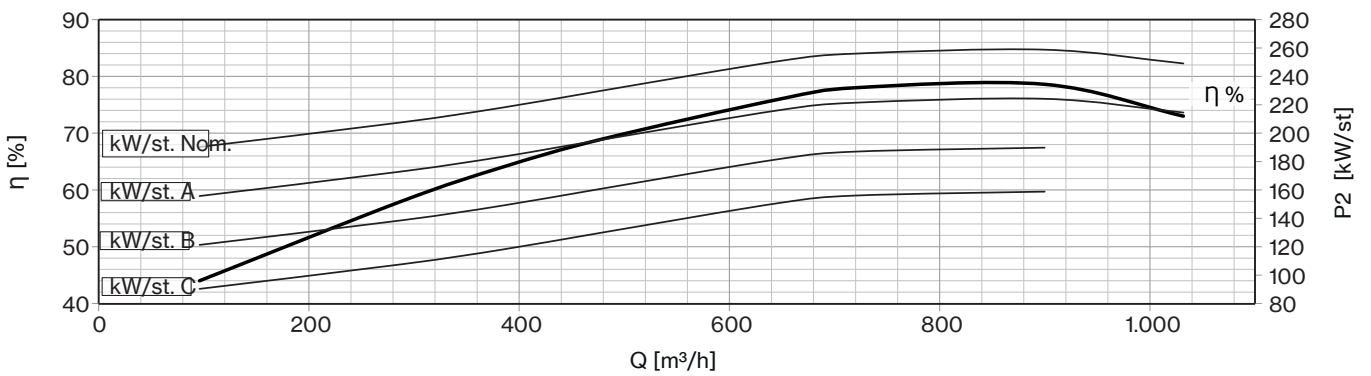
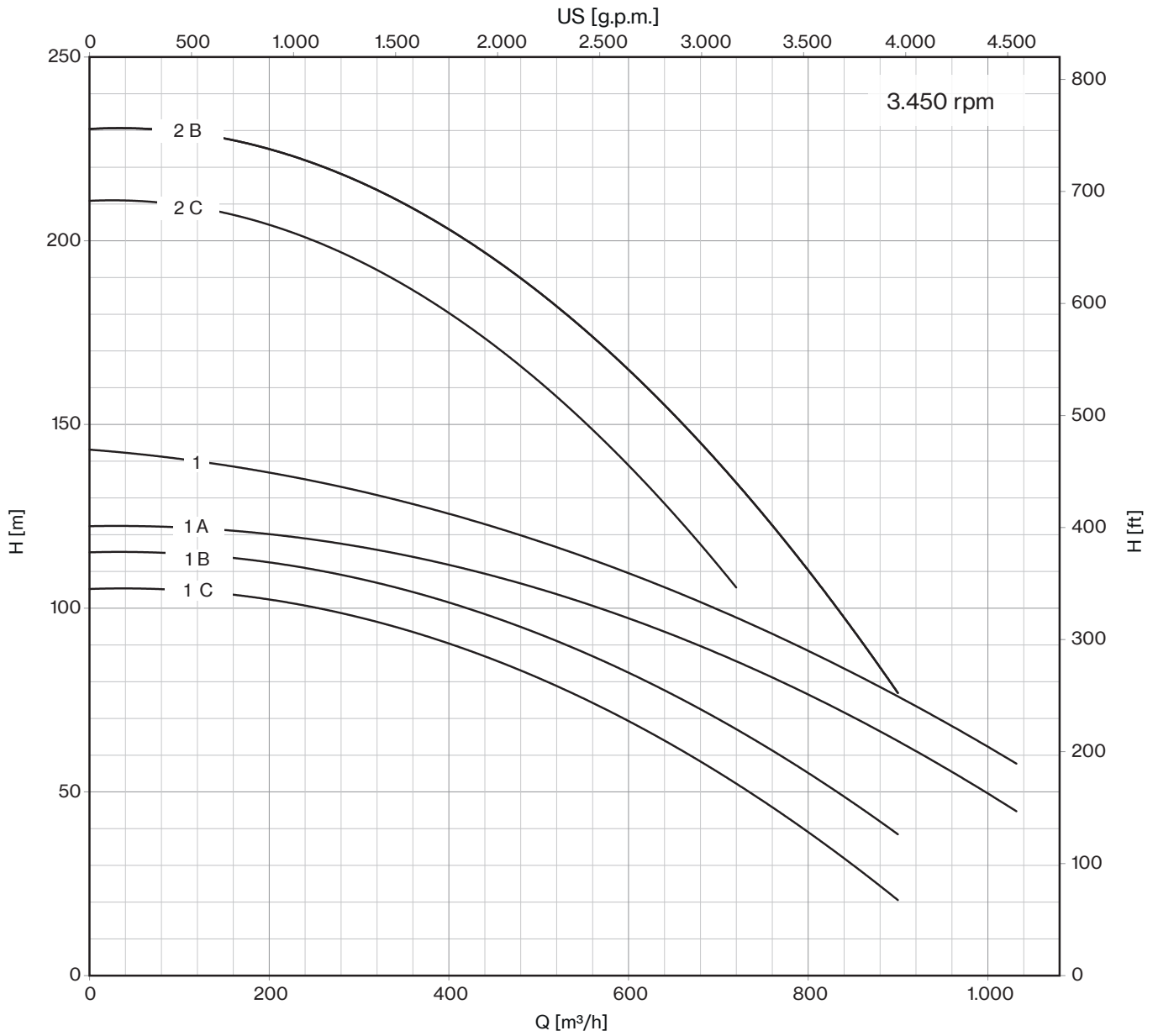

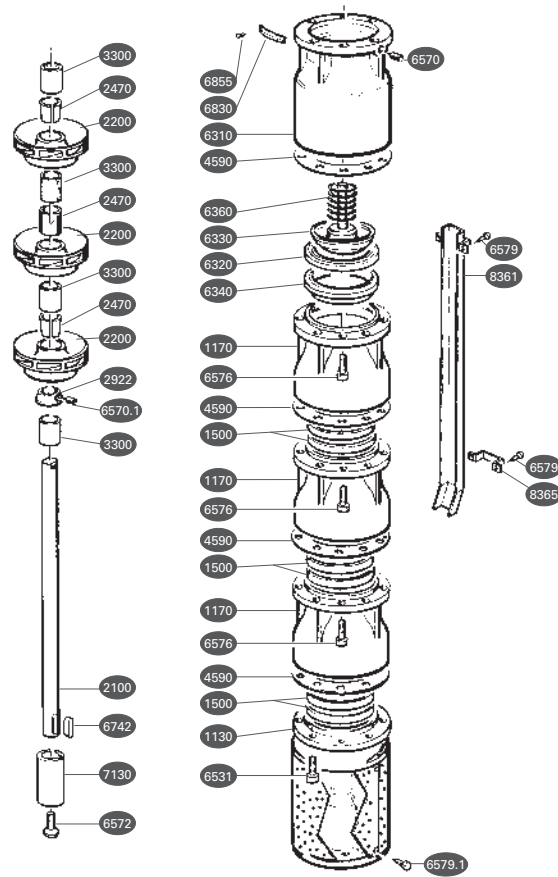

| N° CODE | DESCRIPTION | STANDARD MATERIAL | (*) Q.TY |
|---------|--------------------------|------------------------|-----------|
| 1130 | MOTOR BRACKET | Cast iron | |
| 1170 | DIFFUSER | Cast iron | |
| 1500 | WEAR RING | Rubber | 1 × Stage |
| 2100 | SHAFT | Stainless steel | |
| 2200 | IMPELLER | Cast iron | 1 × Stage |
| 2470 | BUSHING | Steel | 1 × Stage |
| 2922 | SANDGUARD | Brass | |
| 3300 | BEARING | Steel - rubber | 1 × Stage |
| 4590 | GLAND | Guarnital | 1 × Stage |
| 6310 | VALVE BODY | Valve body / Cast Iron | |
| 6320 | VALVE HOUSING | Rubber | |
| 6330 | WASHER | Stainless steel | |
| 6340 | HOUSING RING | Cast iron | |
| 6360 | SPRING | Stainless steel | |
| 6531 | STRAINER | Stainless steel | |
| 6570 | SCREW | Stainless steel | |
| 6570.1 | SCREW | Stainless steel | |
| 6572 | SCREW | Stainless steel | |
| 6576 | SCREW | Stainless steel | |
| 6579 | SCREW | Stainless steel | |
| 6579.1 | SCREW | Stainless steel | |
| 6742 | KEY | Stainless steel | |
| 6830 | LABEL | Stainless steel | |
| 6855 | PIN | Stainless steel | |
| 7130 | JOINT | Stainless steel | |
| 8361 | SHEAT | Stainless steel | |
| 8365 | CABLE GUARD CLAMP | Stainless steel | |

